

MAPS

FIRST FLOOR



Restroom

Student Group Offices

Administrative Office

E Elevator

6



UNIVERSITY MEMORIAL CENTER

MAPS

SECOND FLOOR

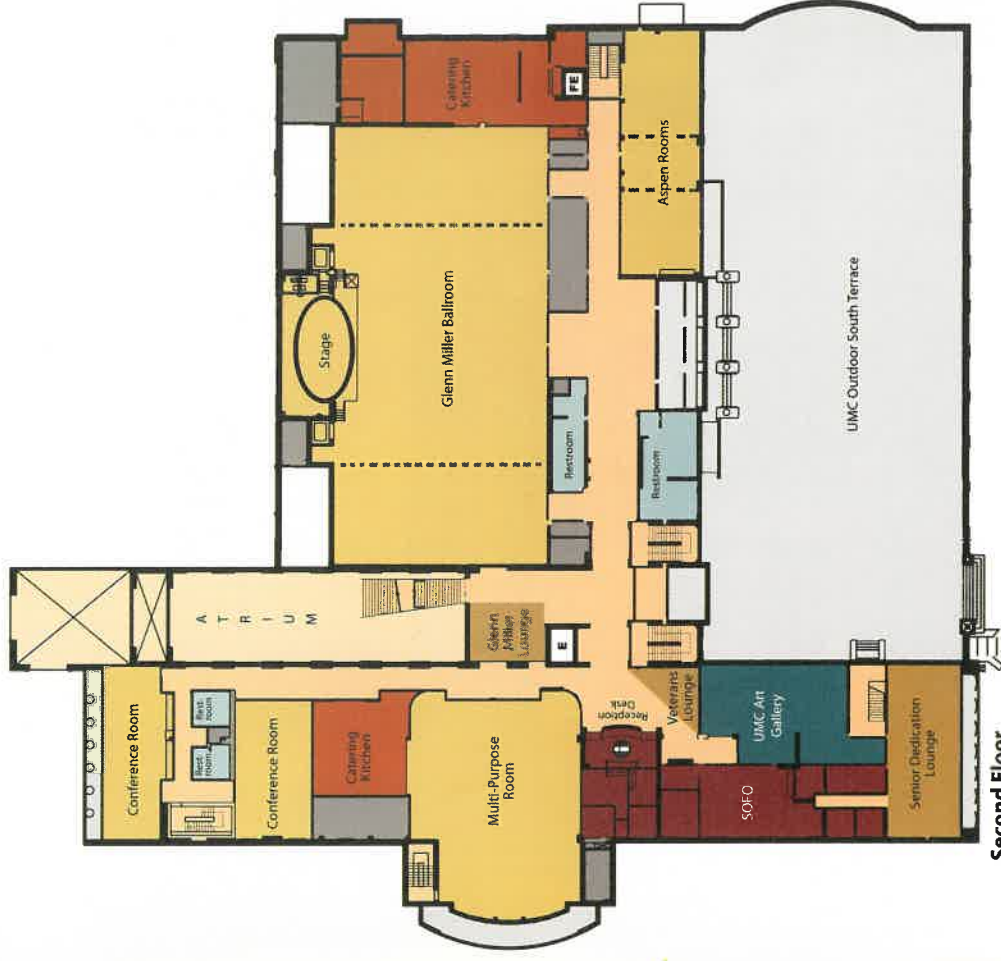

Restroom

Student Group Offices

Administrative Office

E Elevator

i Information Desk



UNIVERSITY MEMORIAL CENTER

MAPS THIRD & FOURTH FLOORS

MAPS FIFTH FLOOR & BASEMENT

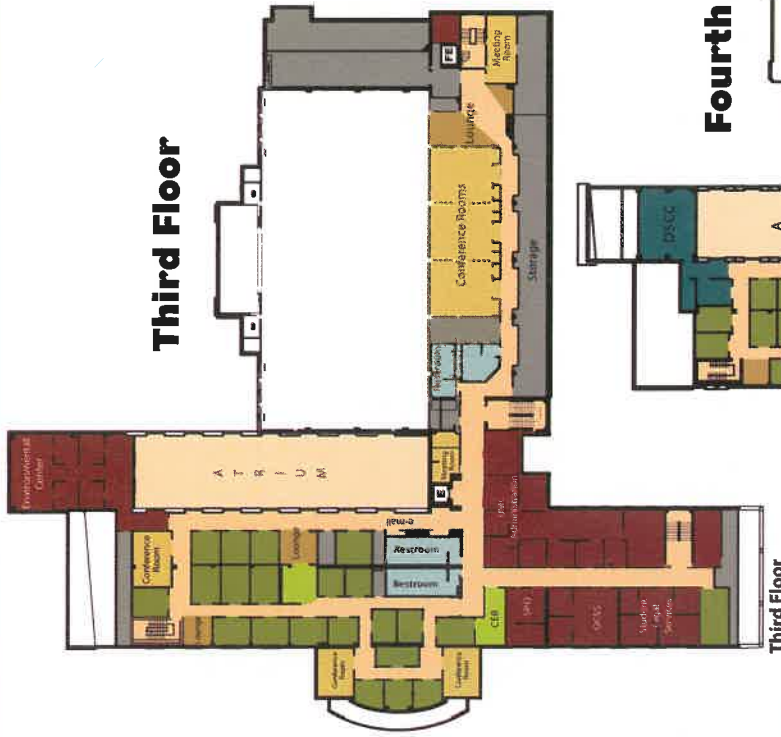

- Restroom
- Student Group Offices
- Administrative Office
- Elevator

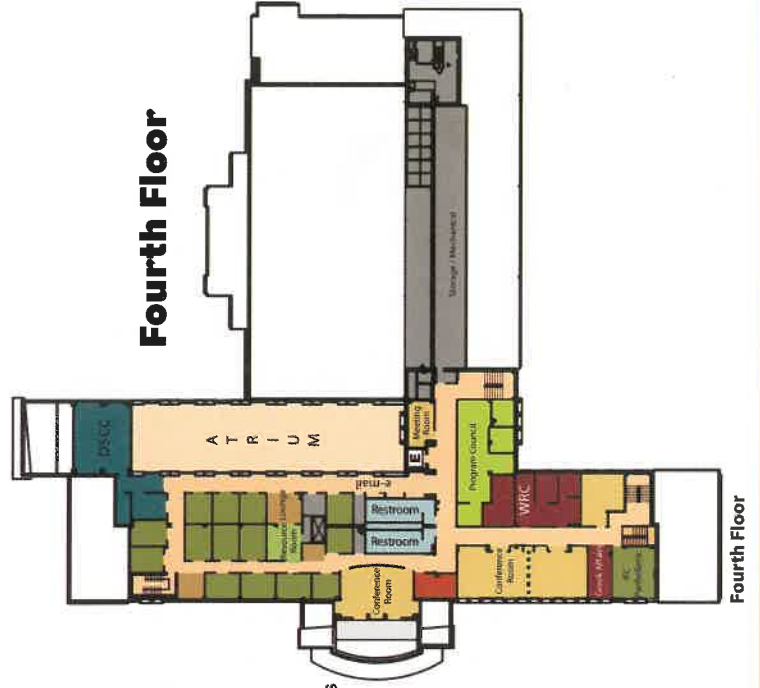

- Restroom
- Student Group Offices
- Administrative Office
- Elevator

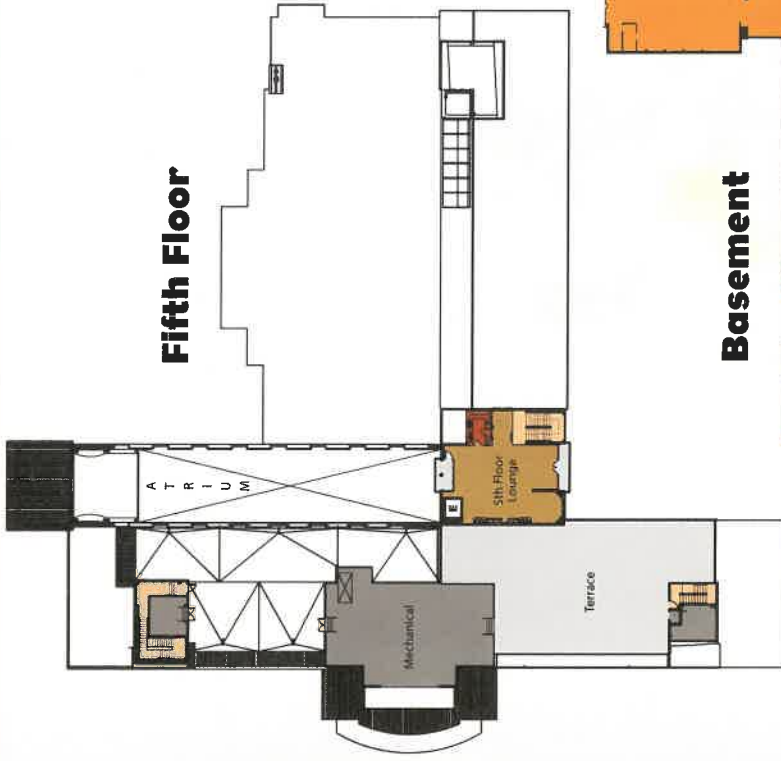

- Restroom
- Student Group Offices
- Administrative Office
- Elevator

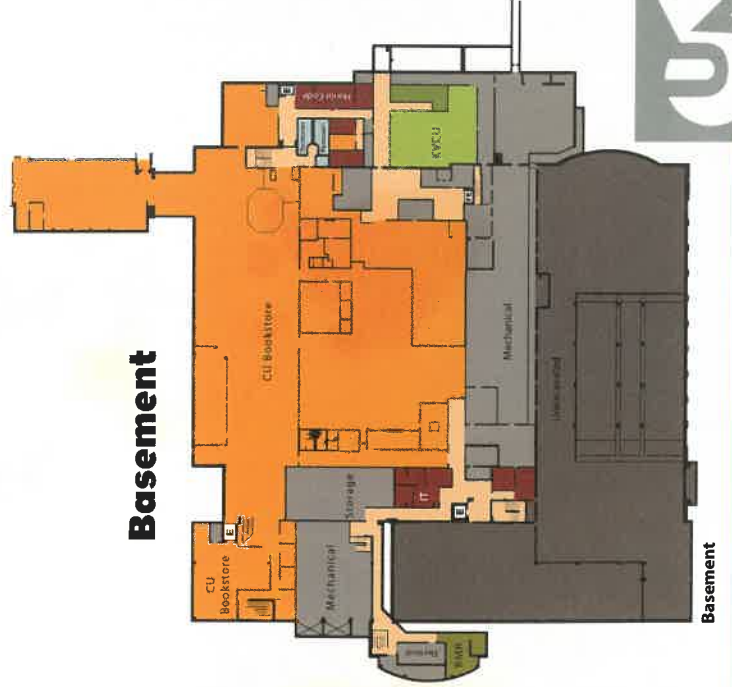

- Restroom
- Student Group Offices
- Administrative Office
- Elevator





CONFERENCE ROOM
235

66' x 54', 3566 s.f.

The Multipurpose Room is designed for many uses. Whether one needs a large space for a banquet, a dance or a lecture hall, this attractive room can provide for it all. Featuring bamboo floors, a balcony with a west view of the Flatirons, variable lighting options for mood and event lighting, and a sound system, this room is guaranteed to be popular.

CONFERENCE ROOM
235

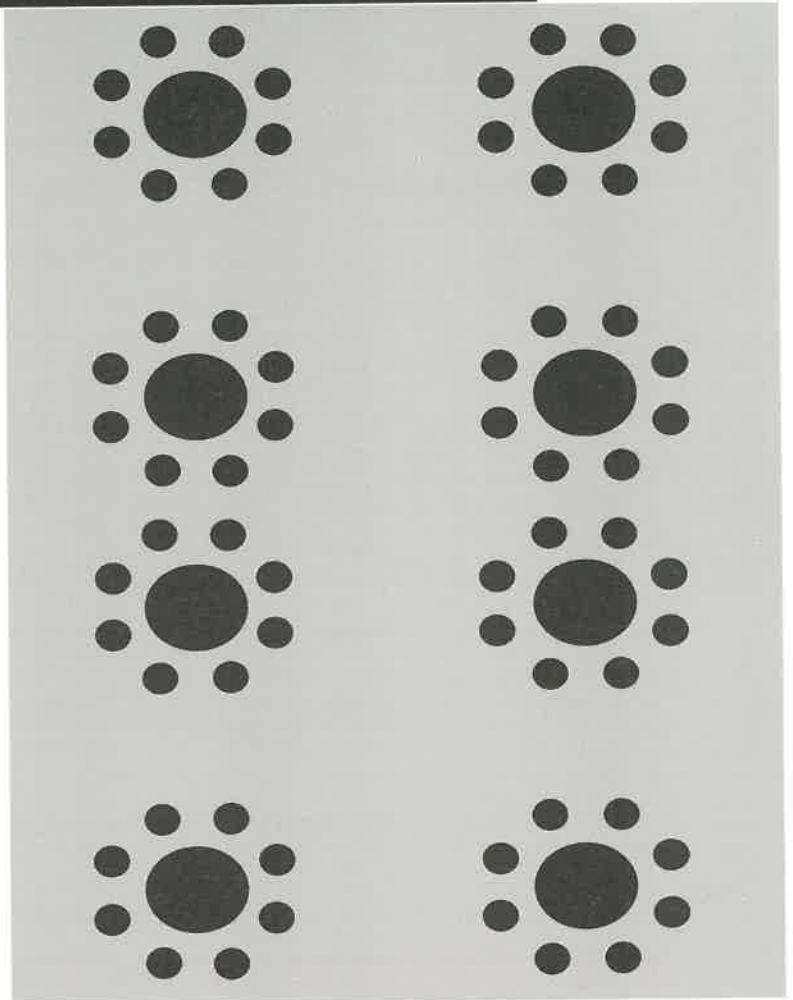

CONFERENCE ROOM
235

Specifications:

- 66' x 54', 3566 s.f.
- 400 person capacity, 300 lecture style, 200 banquet
- Fully interactive presentation capabilities- DVD, VCR, Cable, Computer plug-in, 10' motorized projection screen w/ceiling mounted projector
- Eight different lighting options
- Sound system with PA, microphone, and speakers
- Risers for staging events
- Full catering capabilities



CONFERENCE ROOM 245



CONFERENCE ROOM 245

44' x 24', 1198 s.f.

Ideal for teleconferencing, Room 245 is our high-tech meeting room that features a custom-made table designed specifically to interface with phones, computers, and a variety of video presentations. With natural lighting from two large windows facing west, a variety of artificial lighting options, and a full sound system with PA and speakers, this meeting room has great possibilities for dynamic presentations.

CONFERENCE ROOM
245

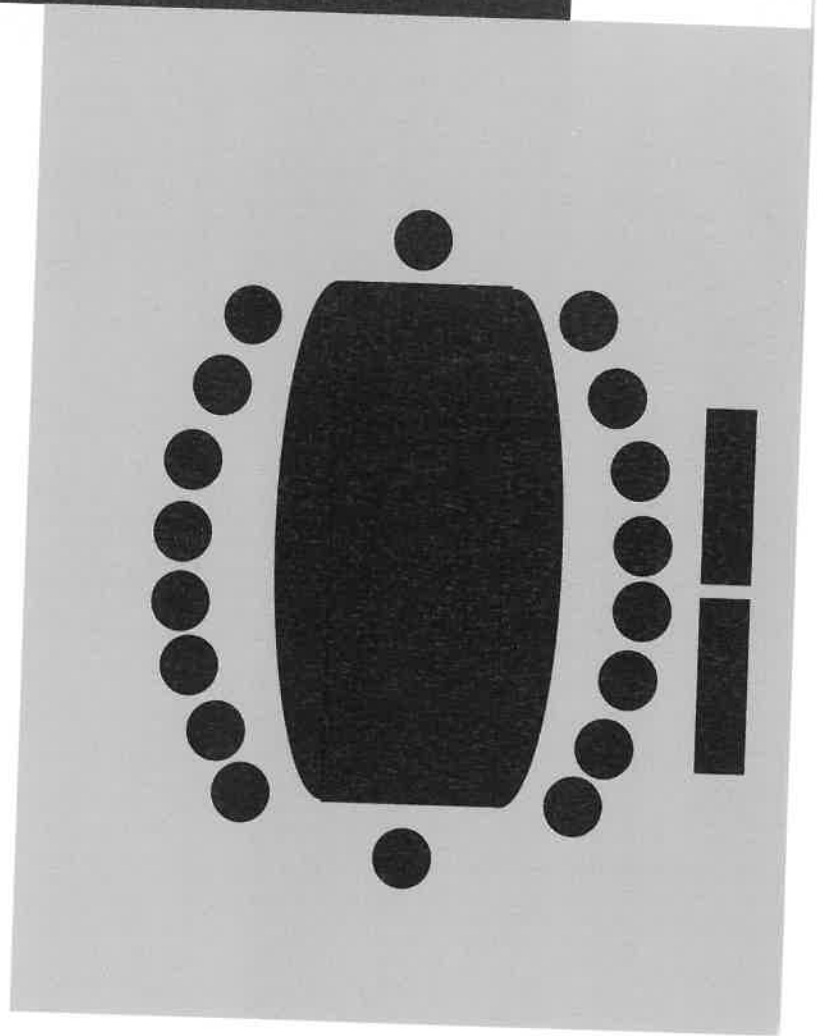

CONFERENCE ROOM
245

Specifications:

- 44' x 24', 1198 s.f.
- 18 seating capacity around custom table
- 21 extra seating capacity around perimeter of room
- Catering capabilities
- Fully interactive presentation capabilities-
DVD, VCR, Cable, Computer plug-in, 8' motorized screen
w/ceiling mounted projector, dry erase board, and
rolling bulletin boards
- Sound system with PA, microphones and speakers



(303) 492.8833

CONFERENCE ROOM 247



CONFERENCE ROOM 247

56.5' x 20', 1130 s.f.

Set up in a classroom style, this attractive meeting room has 21 conference tables with seating for 48 at the tables and 18+ in gallery style. Ideal for lectures and technical presentations, Room 247 has a mounted ceiling projector, a motorized screen on the south wall, a fully equipped sound system, a dry erase board, and dimmable lights. Featuring lots of natural light coming from a wall of windows that faces north, this meeting room also has a pillared balcony with a great view of the Dalton Trumbo Fountain court.

CONFERENCE ROOM

247

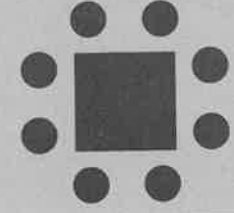
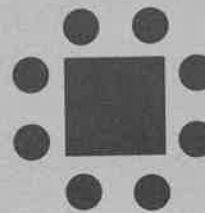
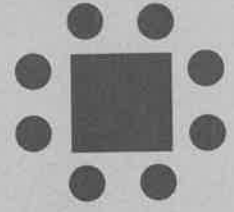
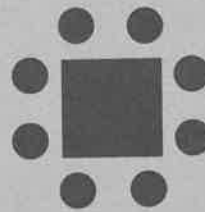
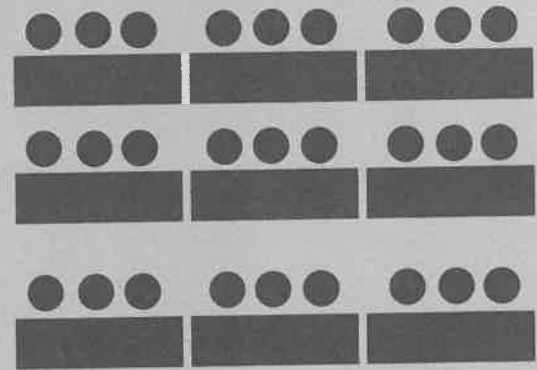

CONFERENCE ROOM

247

Specifications:

- 56.5' x 20'. 1130 s.f.
- 48 classroom seating
- 18 extra seating around perimeter of room
- Catering capabilities
- Fully interactive presentation capabilities, DVD, VCR, Cable, Computer plug-in, 8' motorized screen w/ ceiling mounted projector, dry erase board, and rolling bulletin board
- Sound system with PA, microphones and speakers



(303) 492.8833

CONFERENCE ROOMS

The Aspen Rooms 285, 287, 289



CONFERENCE ROOMS

285, 287, 289 The Aspen Rooms

285: 30' x 24', 720 s.f.

289: 28' x 26', 674 s.f.

287: 17' x 24', 408 s.f.

Combined: 76' x 24', 1920 s.f.

Have summer at any time of year by hosting your events in the Aspen Rooms. These light and airy rooms feature fine dining with an all-window south wall and even a piano. Views out the south wall feature the mountains and our lovely South Terrace. The Aspen Rooms, which can be combined to create one large room or separated to create three more intimate meeting spaces, are a wonderful way to keep that summer spirit alive at any event.

CONFERENCE ROOMS

The Aspen Rooms 285, 287, 289

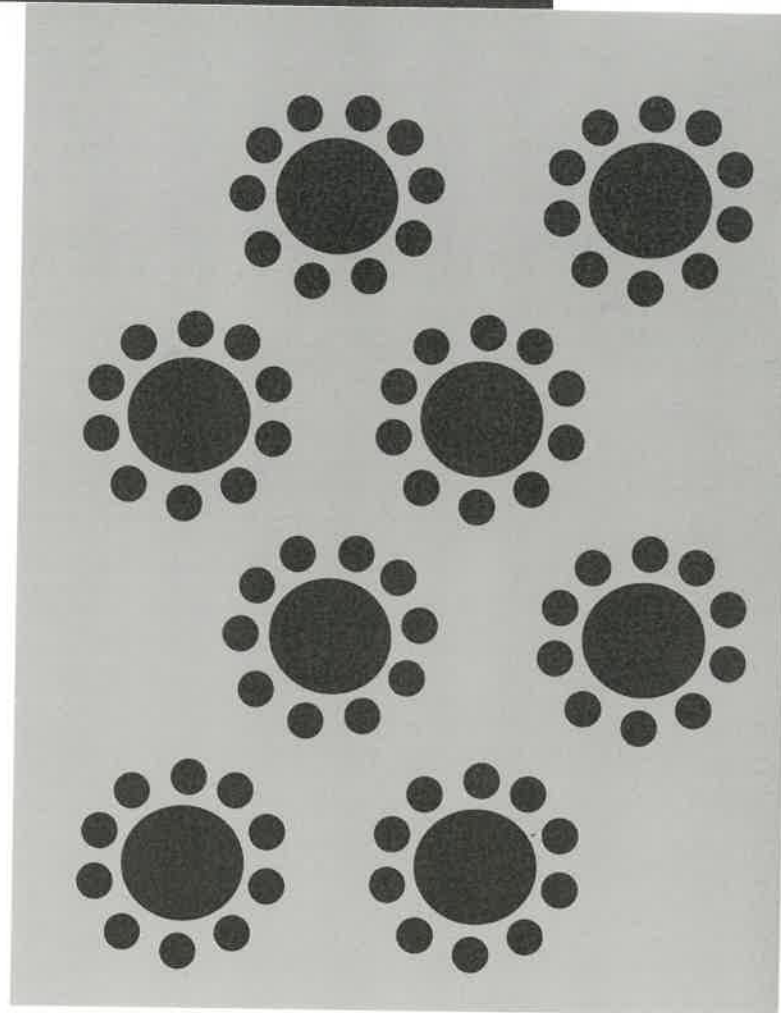

CONFERENCE ROOMS

285, 287, 289 The Aspen Rooms

Specifications:

- *Combined:* 76' x 24', 1920 s.f.
Capacity: 130 lecture, 100 banquet, 120 reception
- *Room 285:* 30' x 24', 720 s.f.
Capacity: 60 lecture, 48 banquet, 50 reception
- *Room 287:* 17' x 24', 408 s.f.
Capacity: 24 for all arrangements
- *Room 289:* 28' x 26', 672 s.f.
Capacity: 40 lecture, 30 banquet, 50 reception
- Portable sound system and audio/visual equipment available
- Catering capabilities



(303) 492.8833

STANDARD CONFERENCE ROOMS

304, 353*, 381, 382, 384, 386, 404, 415, 417



STANDARD CONFERENCE ROOMS

304, 353*, 381, 382, 384, 386, 404, 415, 417

304: 20' x 14.5', 289 s.f.	382: 24' x 36', 601 s.f.	404: 20' x 14.5', 289 s.f.
353: 16' x 22', 365 s.f.	384: 22' x 36', 704 s.f.	415: 24' x 24', 576 s.f.
381: 28' x 14', 354 s.f.	386: 26' x 36', 602 s.f.	417: 24' x 30', 720 s.f.

Though we call our Rooms 304, 353, 381, 382, 384, 386, 404, 415, and 417 standard, they are anything but average. This exceptional series of conference rooms combines elements of design and style with functionality to create the perfect meeting space for any occasion. They are ideal for smaller, more intimate meetings. All have audio-visual equipment available, as well as catering capabilities.

* Room 353 pictured.

STANDARD CONFERENCE ROOMS

304, 353*, 381, 382, 384, 386, 404, 415, 417

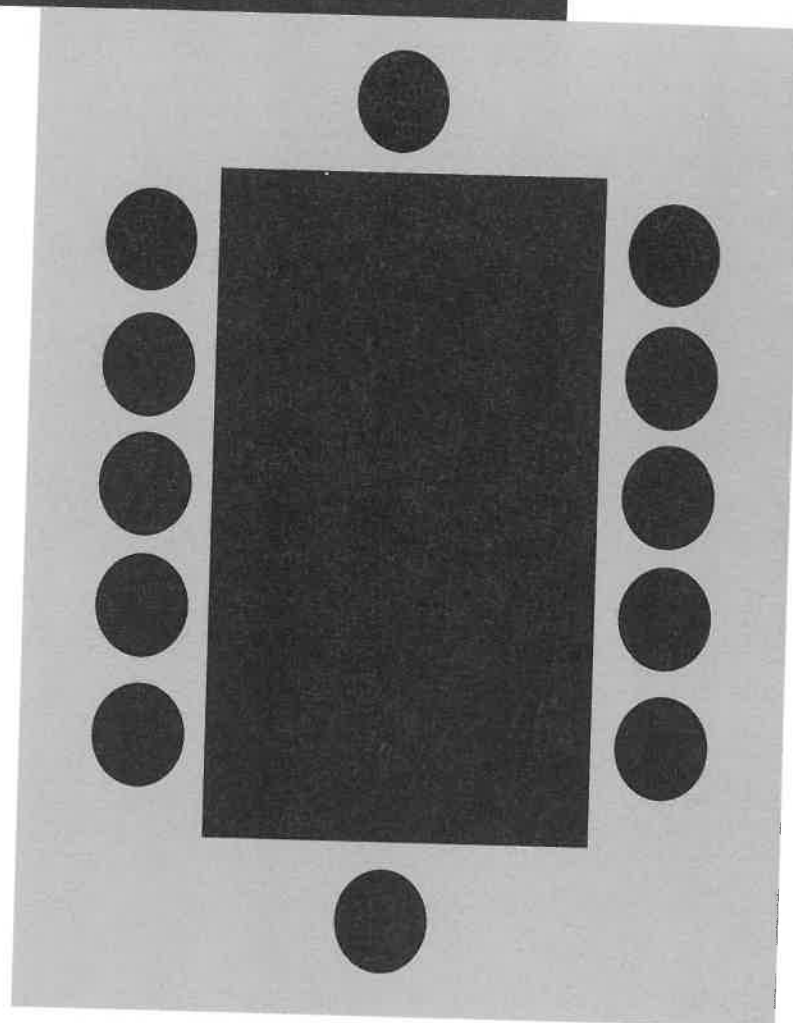

STANDARD CONFERENCE ROOMS

304, 353*, 381, 382, 384, 386, 404, 415, 417

Specifications:

- Rooms 304, 404: 20' x 14.5', 289 s.f.
- Room 353: 16' x 22', 365 s.f.
- Room 381: 28' x 14', 354 s.f.; Room 382: 24' x 36', 601 s.f.
- Room 384: 22' x 36', 704 s.f.; Room 386: 26' x 36', 602 s.f.
- Room 415: 24' x 24', 576 s.f.; Room 417: 24' x 30', 720 s.f.
- Rooms 415 and 417 can be combined
- Capacity 10- 24 people, depending on room
- Movable 27" TV/VCR/Cable accommodations in 304, 404, 353
- Portable TV/VCR/Cable and video projector available and motorized projection screen available in all rooms
- Catering capabilities



(303) 492.8833

CONFERENCE ROOMS 325 & 335



CONFERENCE ROOMS 325 & 335

325 18' x 15', 271 s.f.

335 18' x 15', 270 s.f.

Like mirror images, these meeting rooms feature identical cathedral ceilings and three windows that add natural light and a spacious feeling. Ideal for more intimate meetings, each room has a conference table that seats 10. Equipped with a 27" TV/VCR setup and 6' motorized projection screen, both rooms easily accommodate presentations.

CONFERENCE ROOMS
325 & 335

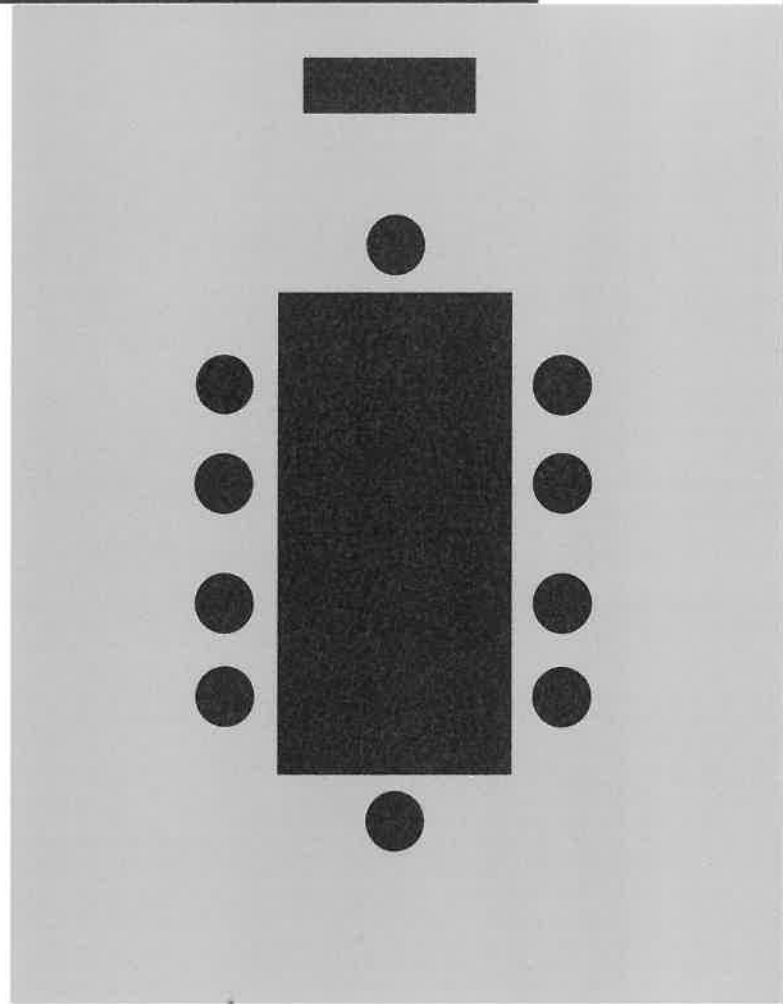

CONFERENCE ROOMS
325 & 335

Specifications:

- 325 18' x 15', 271 s.f.
- 335 18' x 15', 270 s.f.
- Conference table with seating for 10
- Extra seating for 4
- 6' motorized screen, w/ceiling mounted projector, and dry erase board
- Movable TV carts w/27" TV/VCR/cable accommodations
- Dimmable lighting
- Catering capabilities



(303) 492.8833

CONFERENCE ROOM 425



CONFERENCE ROOM 425

30' x 32', 960 s.f.

This distinctive meeting room features a fully windowed west wall, complete with a terrace with gorgeous mountain views. The room also features a beautiful curved wall that adds a unique architectural element to this conference space. Ready to get down to business, this room is fully interactive, with an 8' projection screen and a ceiling mounted projector, dry erase board and dimmable lights. It is the ideal space for both business and pleasure.

CONFERENCE ROOM
425

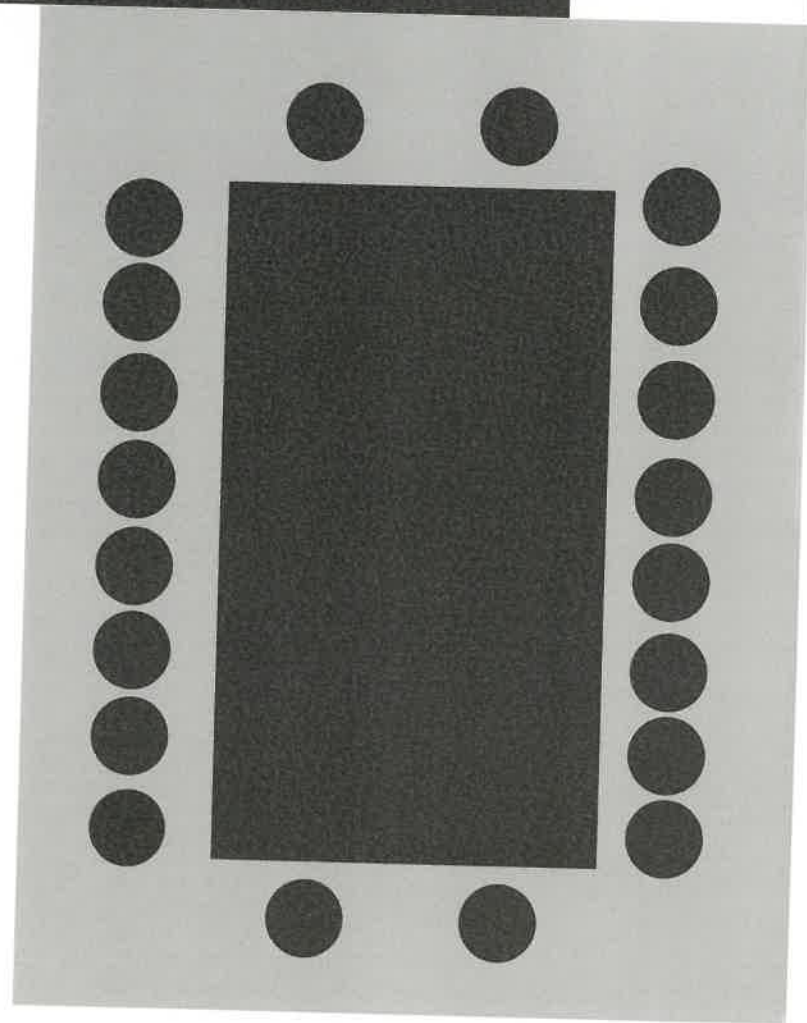

CONFERENCE ROOM
425

Specifications:

- 30' x 32', 960 s.f.
- Capacity 20 people
- Dry erase boards
- Dimmable lights with occupancy sensors
- Sound system with PA, microphones, and speakers
- Fully interactive presentation capabilities- DVD, VCR, Cable, Computer plug-in, 8' motorized projection screen with ceiling mounted projector, dry erase boards, and rolling bulletin boards
- Catering capabilities



(303) 492.8833

CONFERENCE ROOM
Dennis Small Cultural Center 457



CONFERENCE ROOM
457 Dennis Small Cultural Center

26' x 30', 780 s.f.

This spectacular space is unique. It has a two-story vaulted ceiling and views of North campus and the interior of the five-story atrium. Featuring bamboo flooring, colorful fluted interior pillars, and a variety of lighting options, this wonderful space can be used for any number of events. Primarily used as the on-campus cultural center, its availability is contingent upon cultural programming.

CONFERENCE ROOM
457

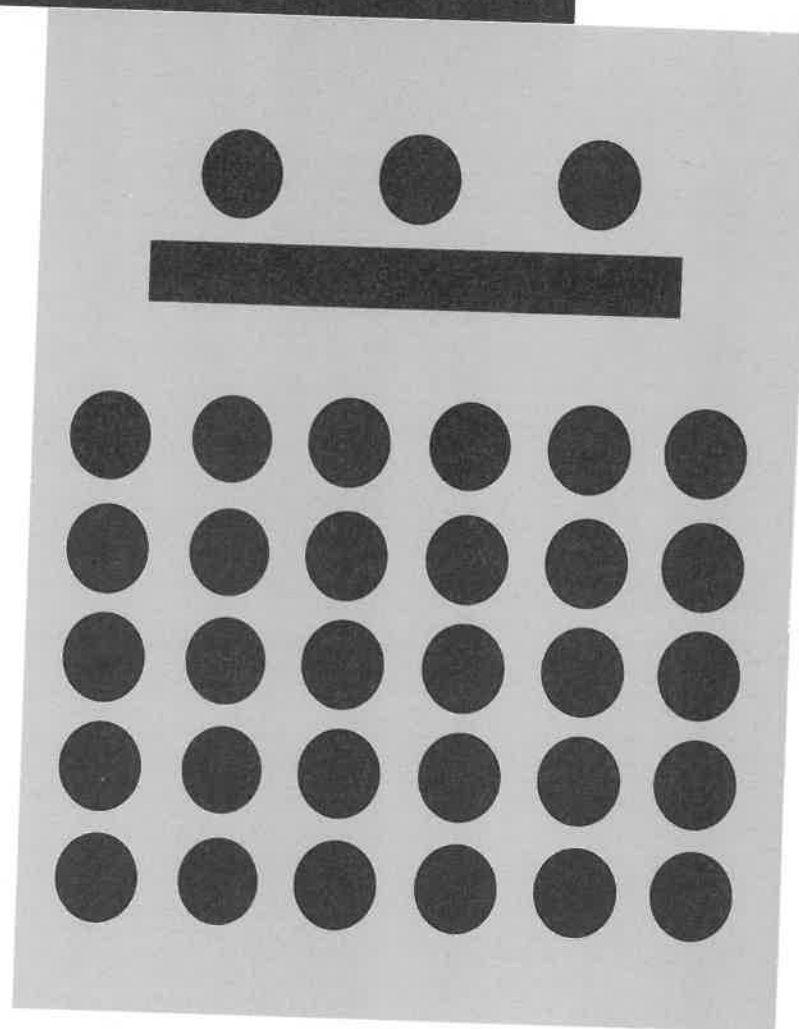

CONFERENCE ROOM

457 Dennis Small Cultural Center

Specifications:

- 26' x 30', 780 s.f.
- 30 theater/lecture style
- Dry erase boards
- Programmable, dimmable lights
- New sound system
- 27" TV/VCR/Cable accommodations
- Catering capabilities



(303) 492.8833

RECEPTION AREA Atrium



RECEPTION AREA Atrium

28' x 112', 3136 s.f.

The best and brightest of the new UMC, this space features a five-story windowed atrium, a cascading stairway, and outdoor beauty. This open room is filled with natural light, which highlights its sandstone and wood paneled walls. The Atrium proves to be a wonderful setting for wedding, business, or social receptions. Our premier catering is also available to complement any reception held within the Atrium.

RECEPTION AREA
Atrium



RECEPTION AREA
Atrium

Specifications:

- 28' x 112', 3136 s.f.
- Capacity: 200 person reception
- Catering capabilities



(303) 492.8833

CONFERENCE ROOMS Glenn Miller Ballroom



CONFERENCE ROOMS Glenn Miller Ballroom

East Ballroom: 34' x 68', 2312 s.f.

West Ballroom: 34' x 68', 2312 s.f.

Center Ballroom: 70.5' x 16', 4794 s.f.

Combined: 138.5' x 68', 9418 s.f.

Having an extra-large event? Experience our newly renovated Glenn Miller Ballroom. You can rent all or part of this spacious yet intimate room for a variety of events. With a multipurpose stage, catering capabilities, and a built in sound system, it is sure to fit all your needs; but there is no need to sacrifice beauty for function. The Ballroom has a wonderful decor, with hardwood flooring fit to be walked upon by the glass slippers of Cinderella herself!

CONFERENCE ROOMS
Glenn Miller Ballroom

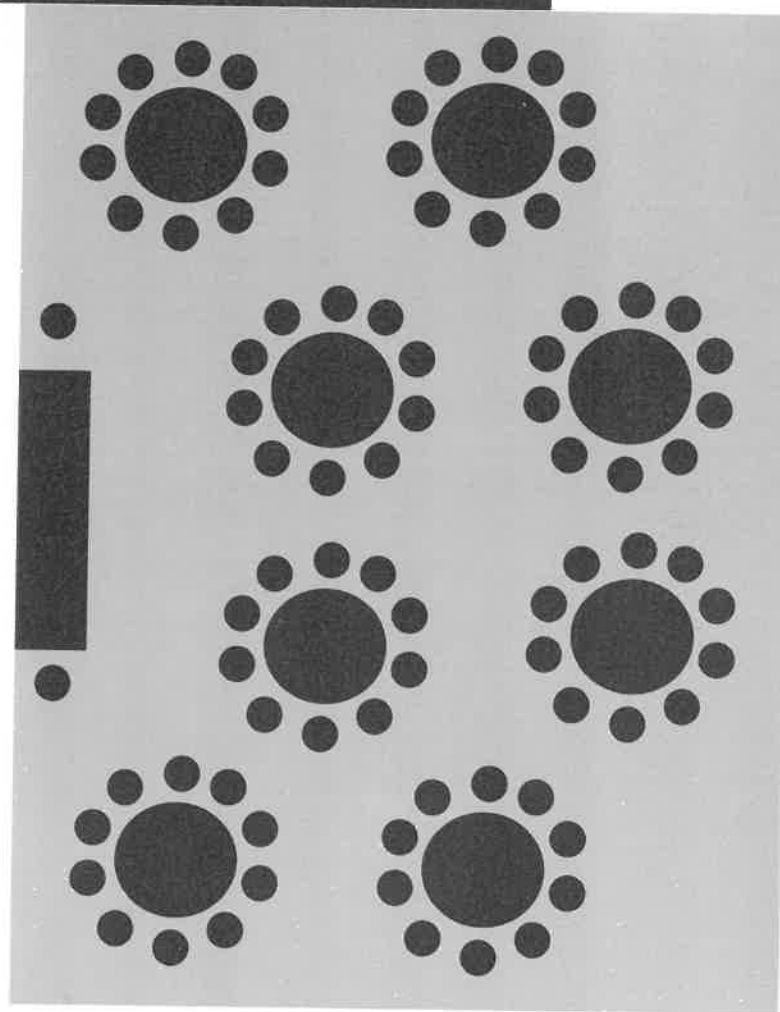

CONFERENCE ROOMS
Glenn Miller Ballroom

Specifications:

- *Combined 138.5' x 68', 9418 s.f.*
Capacity: 1200 lecture, 500 banquet, 700 reception
- *Middle Ballroom: 70.5' x 16', 4794 s.f.*
Capacity: 600 lecture, 250 banquet, 300 reception
- *East and West Ballrooms: 34' x 68', 2312 s.f.*
Capacity: 280 lecture, 120 banquet, 200 reception
- Built-in sound system, variety of lighting options, stage and projection screens available
- Catering capabilities



(303) 492.8833