

Spiritual Detachment

Architect: Luke Bowers
Client: Spencer Vu

As Spencer arrives to the space via bike, he enters and detaches from the outside world, letting go of objects like shoes and keys, and transitions into peace, serenity, and calm. In the space he takes part in spiritual activities while letting his mind and its thoughts wander. There is also space for reflection and reading. The chosen site is very shaded and heavily outfitted with trees. This is something Spencer loves, a space of seclusion and privacy. The space feels magical, almost straight out of Hogwarts with its gothic design elements, stained glass, dark wood floors, flooded bookshelves, oriental rugs, etc. The space feels like home to Spencer and serves as a space for him to escape and really focus on himself and his morals.

Design Objectives

- 1: Create a space of detachment
- 2: Create a space of peace
- 3: Create a space where Spencer can enjoy his spirituality and let his mind wander



Montage



Program Diagram

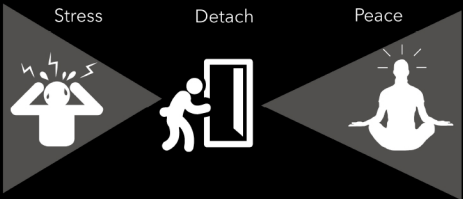

Key Vignette Views

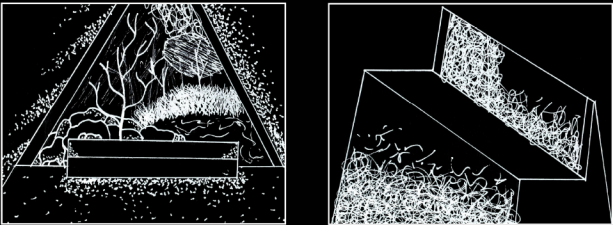

Site Analysis

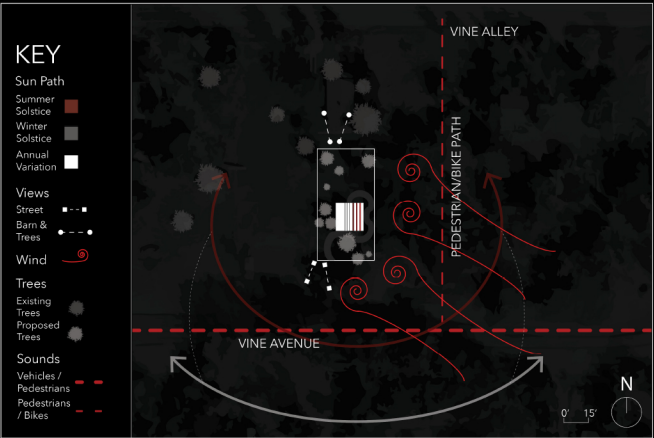

Parti Model

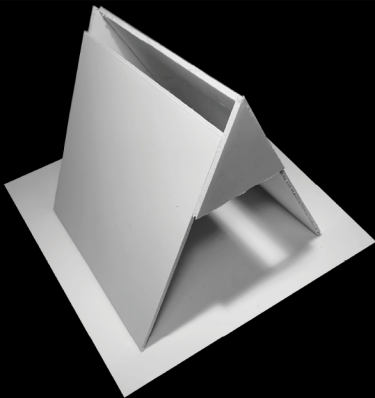

Spiritual Detachment

Architect: Luke Bowers
Client: Spencer Vu

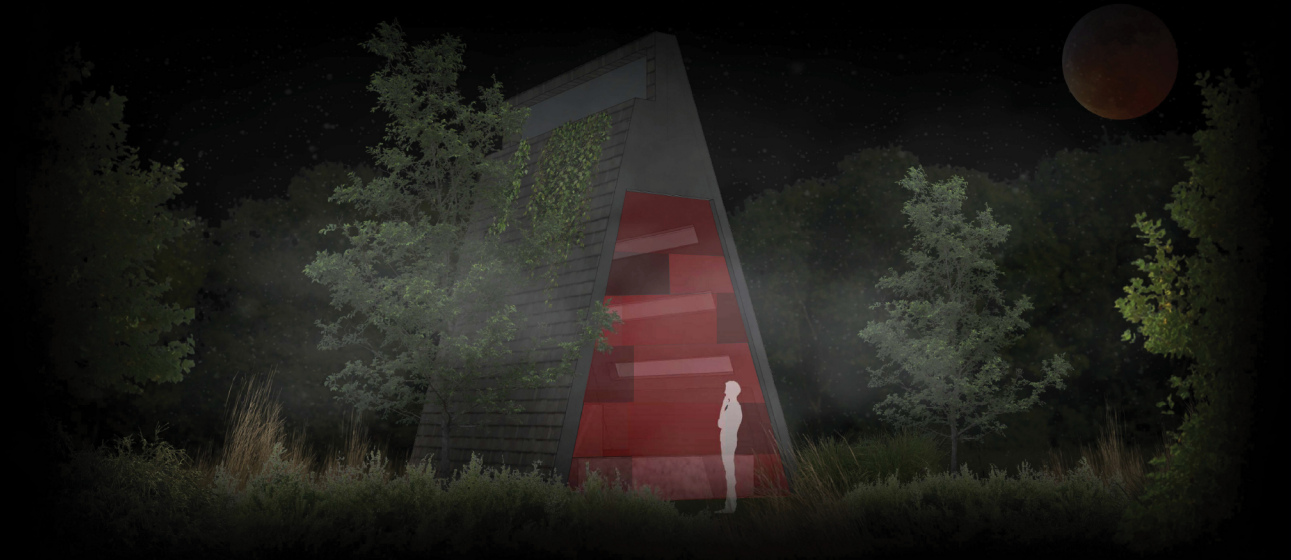

Rendered Perspective



Section A (South)

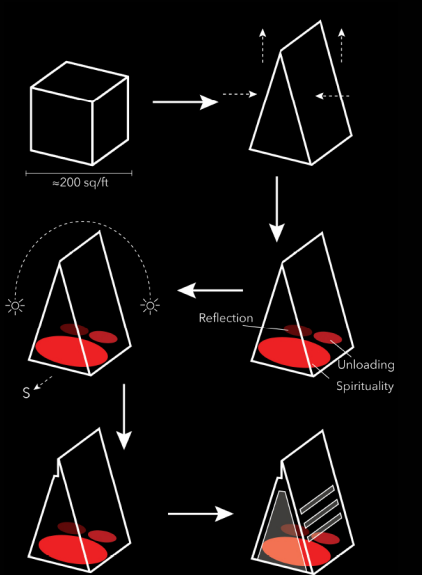

Process Study



Section B (East)

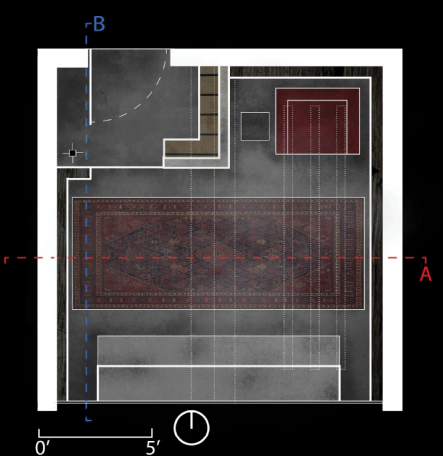

Floor Plan

Spiritual Detachment

Architect: Luke Bowers
Client: Spencer Vu

Physical Model Images

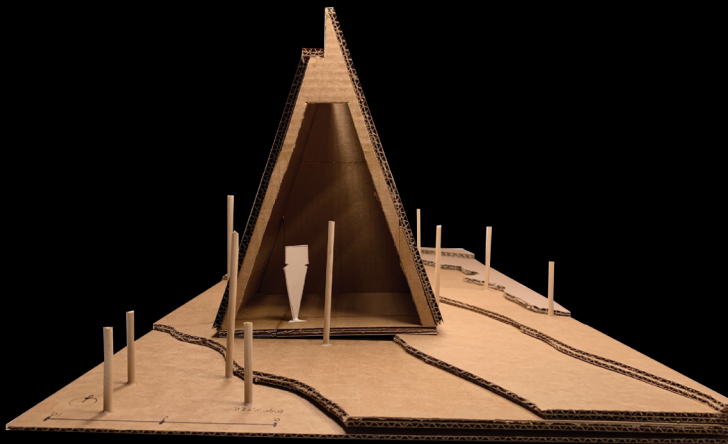

View 1 (Looking North)

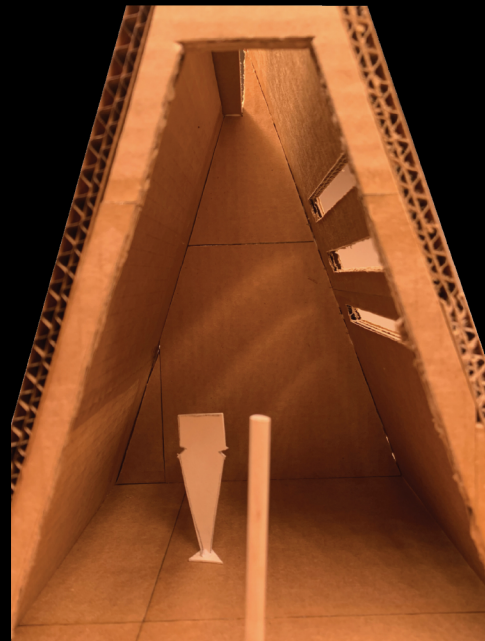

View 2 (Indoor Light Study)

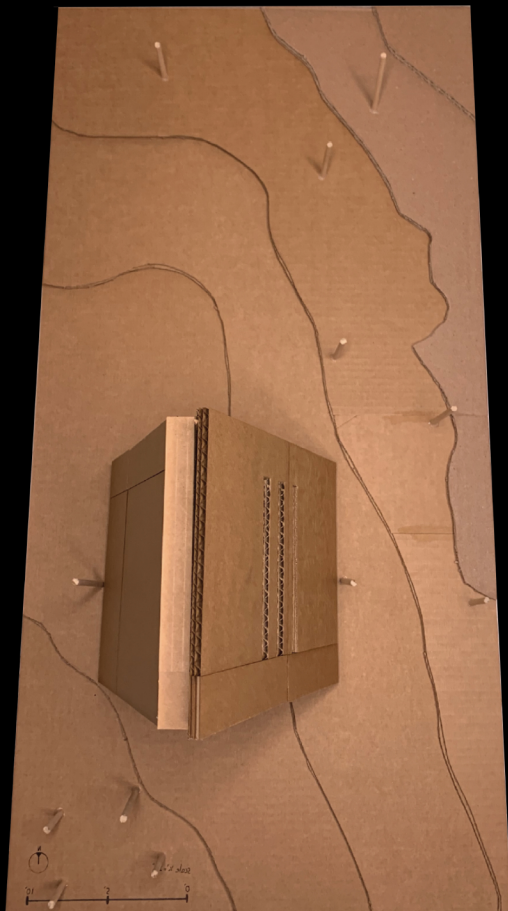

View 3 (Birds Eye View)

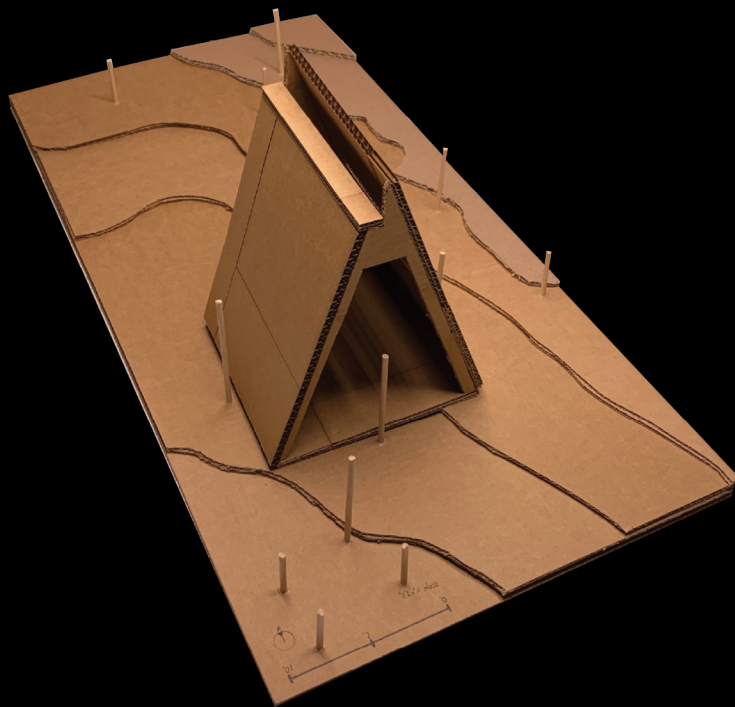

View 4 (Perspective View)