

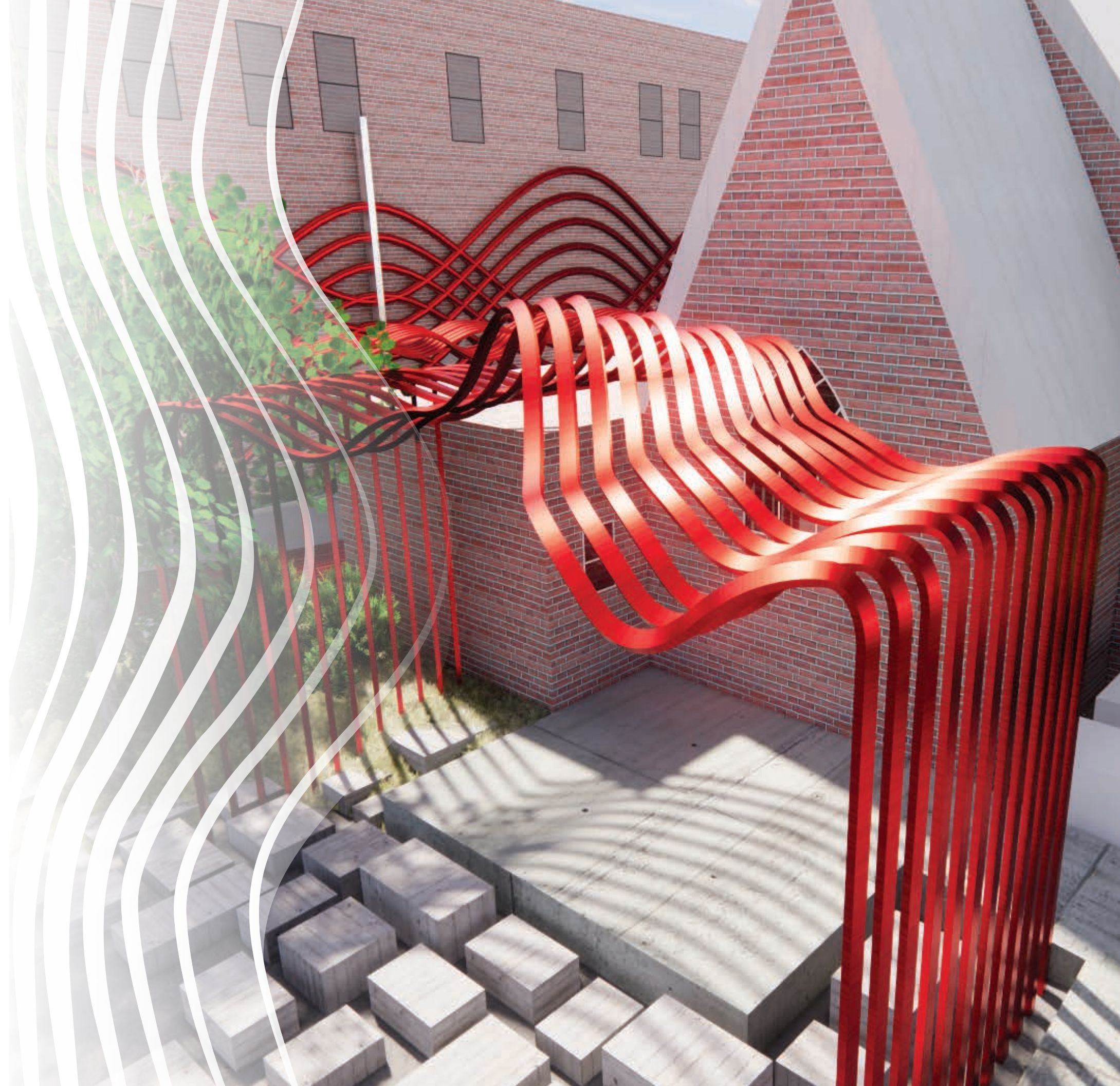

Art Envisioned

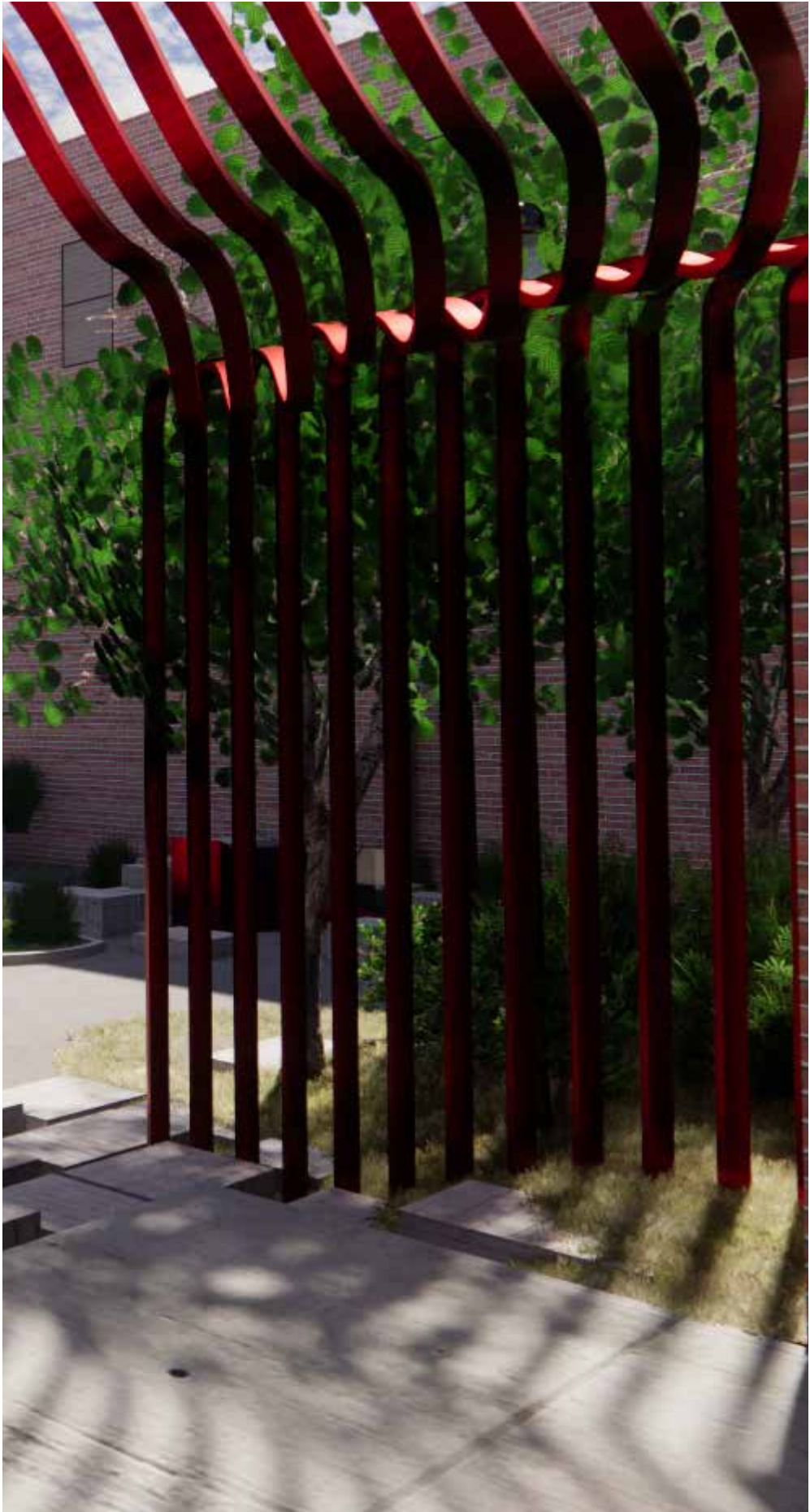

Contacts



LAND 4100: Landscape Architecture Capstone 2020 Instructor: Jesse Van Horne

Client: Longmont Downtown Development Authority Site: St. Stephen's Plaza

Designers:

Riley Chustz

rich5537@colorado.edu
(225) 287 - 6489

Camden Hocker

caho7134@colorado.edu
(303) 999 - 7899

McKinley Parks

mckinley.parks@colorado.edu
(720) 345 - 2669

Logan Phelps

loph1936@colorado.edu
(973) 747 9806

Miles Shapleigh

smiles.hapleigh@gmail.com
(831) 420 - 7828

Site Narrative

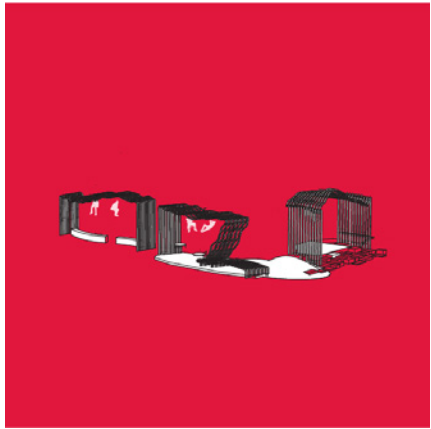

The Ribbon

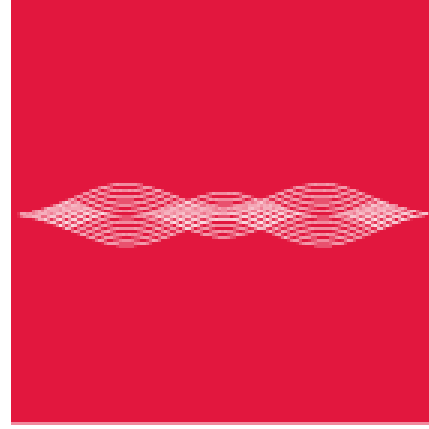

Ribbon Wall

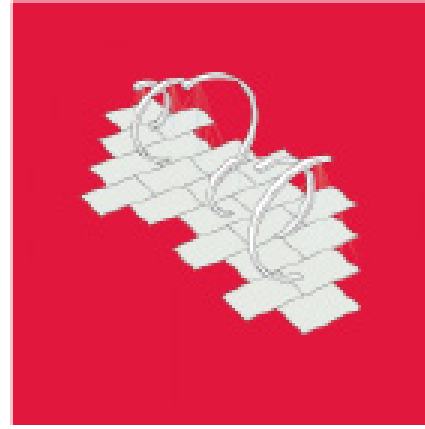

Fountain

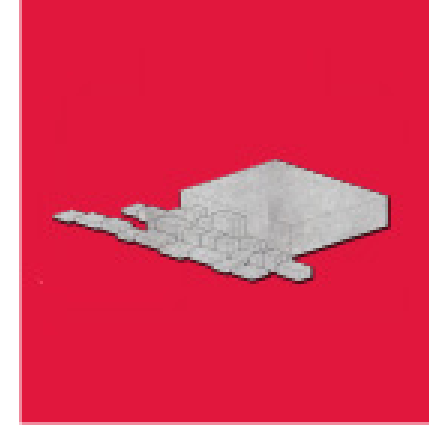

The Stage

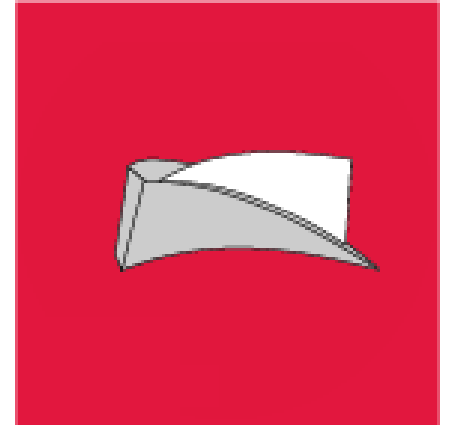

Fire Feature

Despite the issues of St. Stephen's Plaza, it has the potential to be a lively space. The current design does not maximize the space available on the site and does not seem to lend itself to accommodating the beautiful works produced by local artists. Additionally, the site struggles to maintain interest beyond the spring and summer months and often feels cold and uninviting during the winter. Our proposed redesign of the plaza will incorporate art into the functional aspects of the site, while still prominently featuring works added on a rotating basis. It also offers more natural circulation and creates an environment more suited to hosting events and large gatherings, as well as individuals and small groups. Finally, our redesign will create a more inviting atmosphere year-round by providing both plantings and programmatic elements that maintain winter interest.

Longmont Creative District Context

St. Stephen's Plaza sits right off Main Street which tends to see heavy traffic throughout the day. This placement including its central position in Longmont's developing Creative District puts the plaza in a prime position to become a creative node for Longmont. By functioning as a gathering space, event space, site of art, the plaza will become a attraction that can help define Longmont creatively.

Main Street Parade's



Heavy Traffic



Ken Pratt Blvd.

St. Stephen's Plaza

Cafe's and Bars

US 287

LONGMONT

Art as Identity

The overall concept for the redesign of St. Stephen's Plaza incorporates art into the functional areas of the site in a way that coincides with the creative district's identity and facilitates larger gatherings and events. These additions, along with a careful selection of plants, will make the space more lively throughout the day and year.

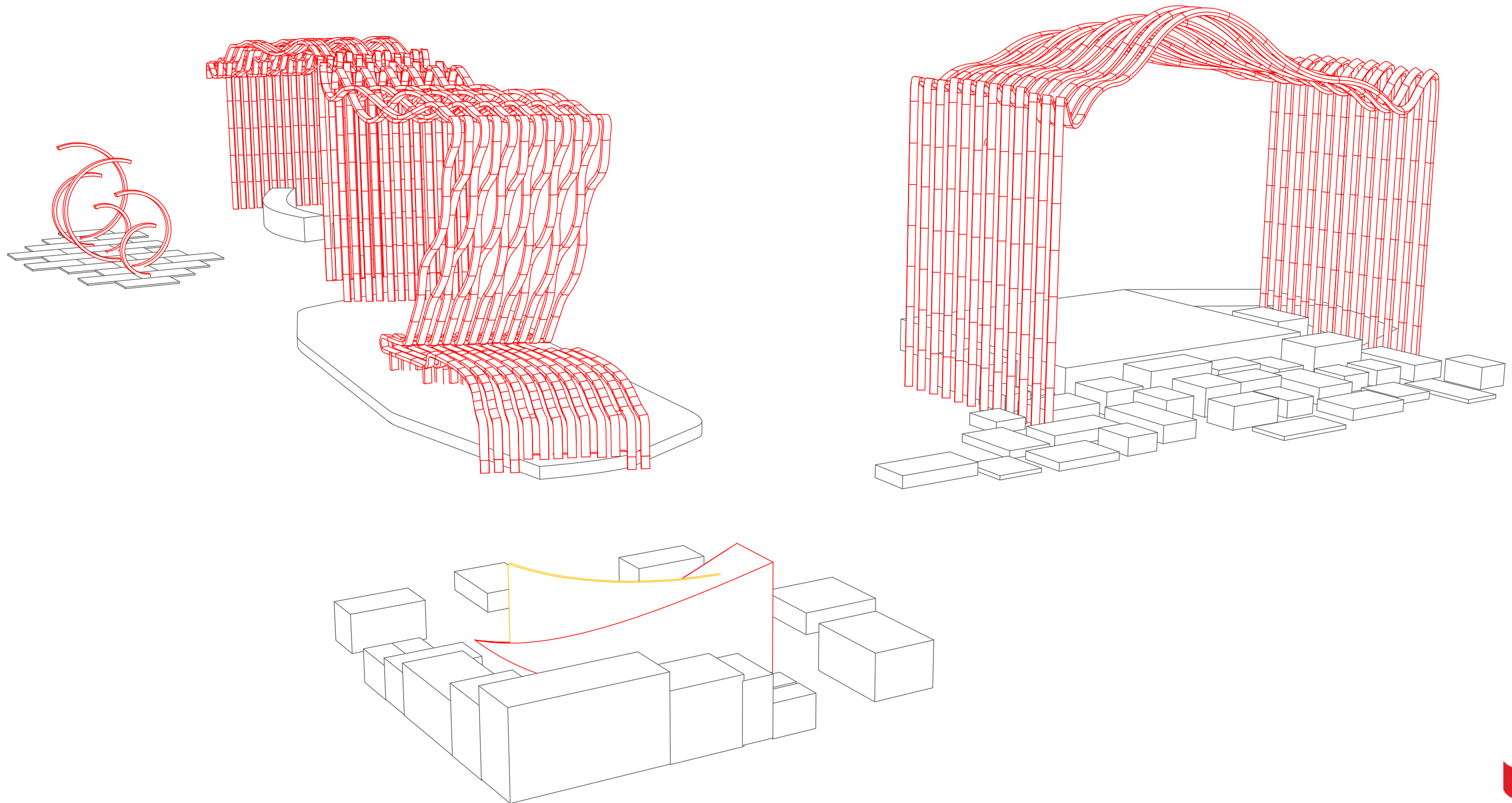

Site Plan



- 1 New Plantings
- 2 The Ribbon
- 3 Fountain
- 4 Wall Ribbon
- 5 Art Pedestals
- 6 Fire Feature
- 7 The Stage
- 8 Ribbon Play

0 5 10 15



Site Issues / Site Visit



Further Connect St. Stephen's Plaza to the Creative District

How can the plaza build its identity to become an attraction in Longmont's creative district?



Emphasize Art in St. Stephen's Plaza

The plaza already has an unique program of art, how can we emphasis interaction with it?



Improve Interest and Efficiency of Plantings

We identified that the plants and plant beds could be improved to create more winter interest, less maintenance, and meaning.



Make a Place that Harbors Gatherings

St. Stephen's struggles with creating meaningful gathering spaces with a leaking fountain, lack of open space, and engaging, identifiable elements.

Issues & Inspiration | Ribbon



Pitfalls of the Colored Walkway

Colored Walkway was a welcomed connecting feature throughout the plaza.

The color and prompts were prompting and inspiring.

However during colder months snow vastly minimized its impact.

How can in the plaza's redesign improve on the function of the colored walkway.



Color, Verticality, and Interaction

Upgrade the colored walkway into something that makes the plaza an identifiable node of Longmont's Creative District.

Adding verticality can create an installation whose form is artistic.

Color moving throughout the site can connect all the different sections of the plaza.

Design a form that encourages interaction, how can it act as seating, shade and art at the same time?

The Ribbon's Function

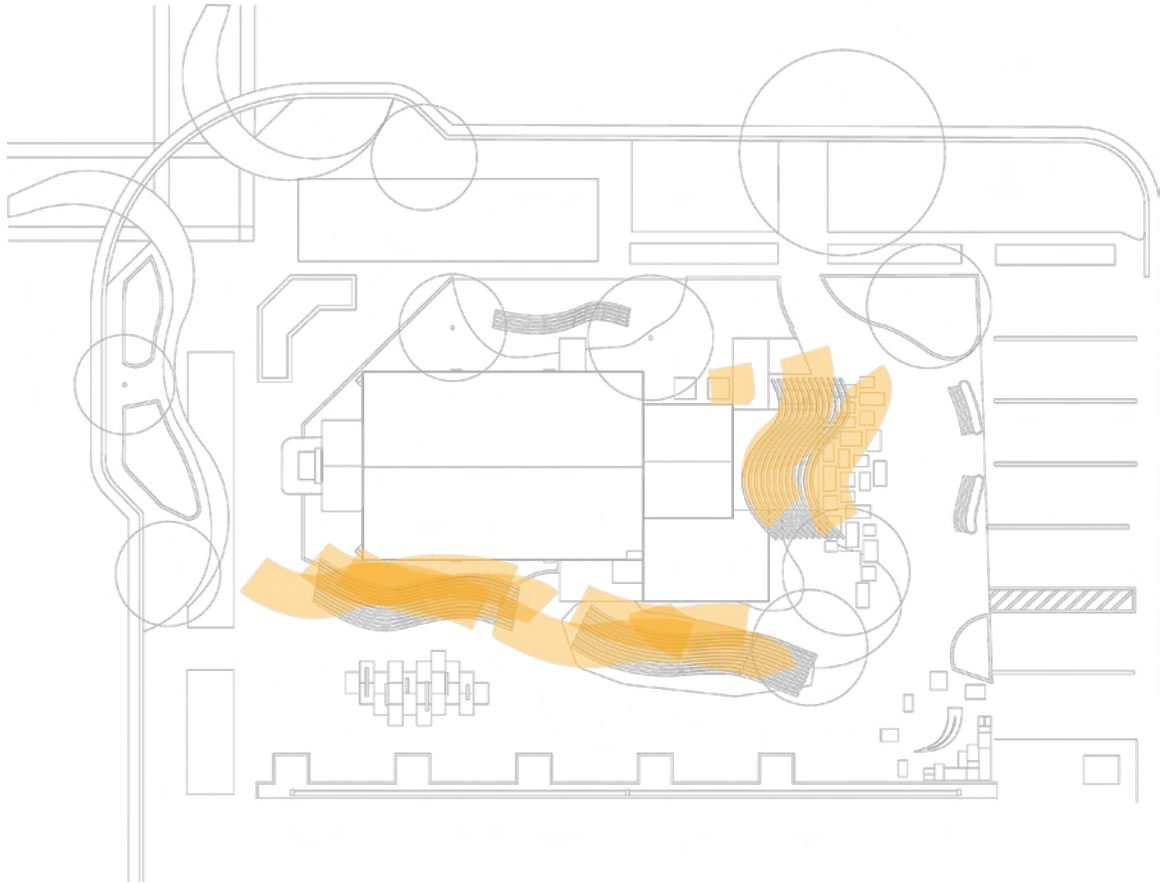

Shade Creation

Shaded Area

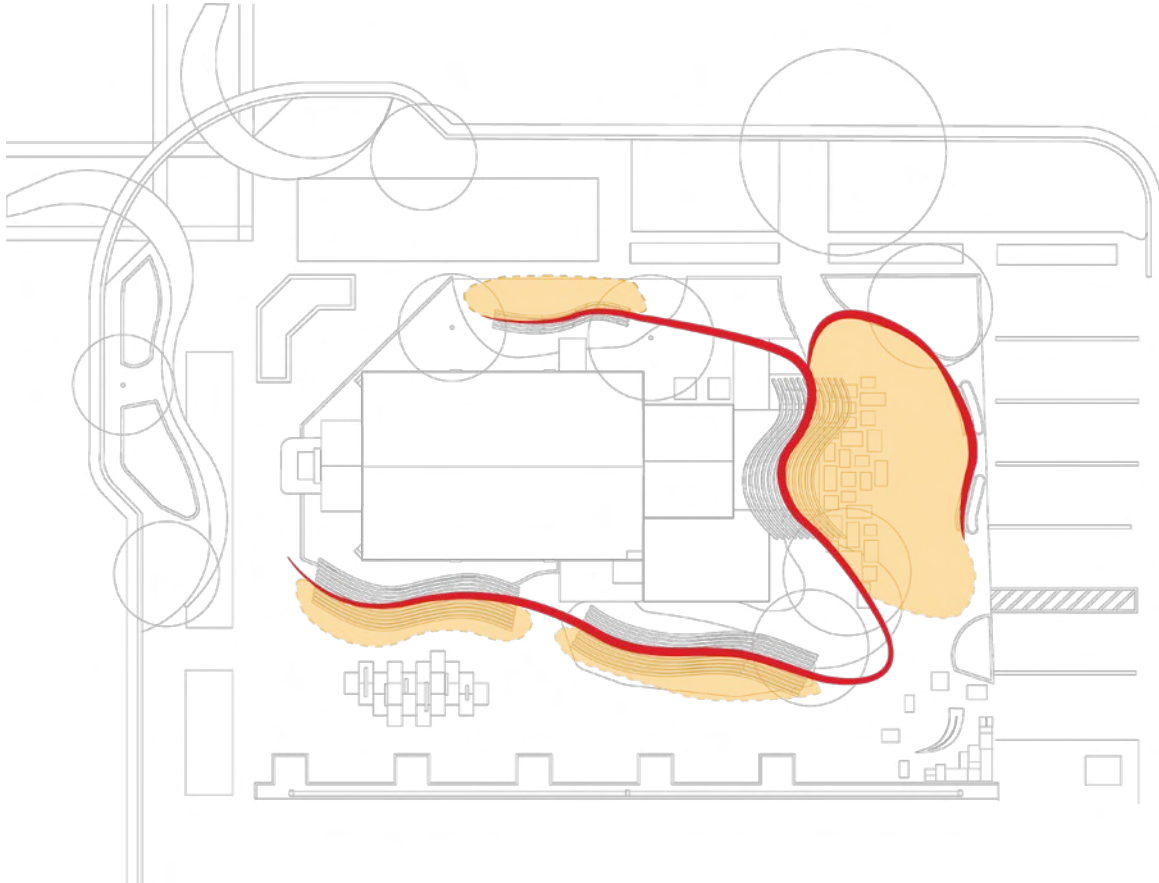

Space Creation

Shaded Area

Gathering Area



Heat Mitigation

Plants mitigate radiating heat from brick wall

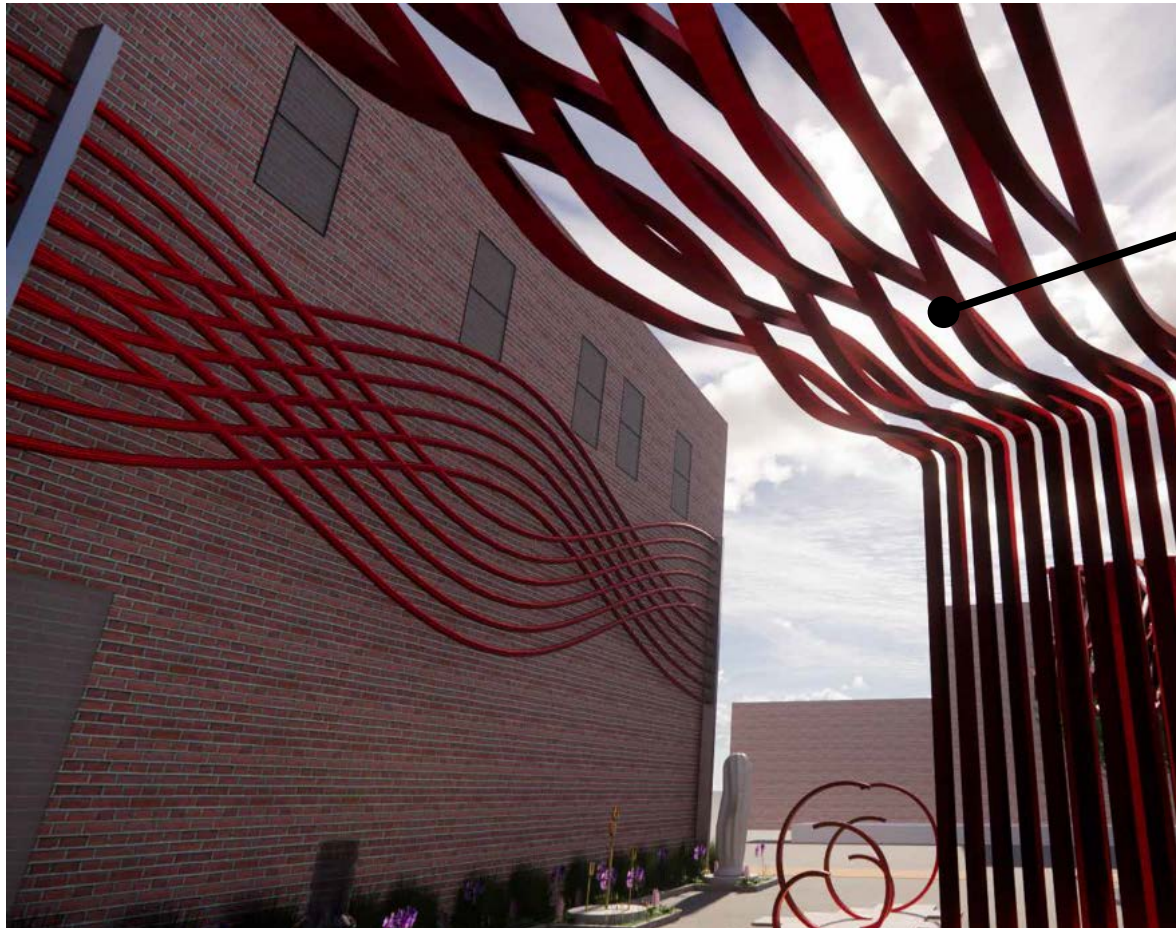

Art Identity

Shade of Ribbon takes up an artistic form

The Ribbon Details

Play Area
The Ribbon now takes the shape of a slide for kids

Guiding Color
Flows through the whole plaza acting as wayfinding.

More Shade
By adding more rods, the Ribbon creates more shade

17' Tall
Increased helps open up the space to encourage gathering

12' Tall
Height allows user room to breathe, while discouraging the ability to hang on it

Interactive Form
While the form changes to encourage different interactions, the top does not allow users to get on top

Ribbon Form
The artistic flow of the Ribbon makes it an identifiable element of the plaza

Paint Coating
Powder paint coating will reduce heat retention

2x4" Metal Rods
12 undulating rods create a ribbon like flow above the users head.

Ribbon Perspective



Ribbon Play



Ribbon Wall

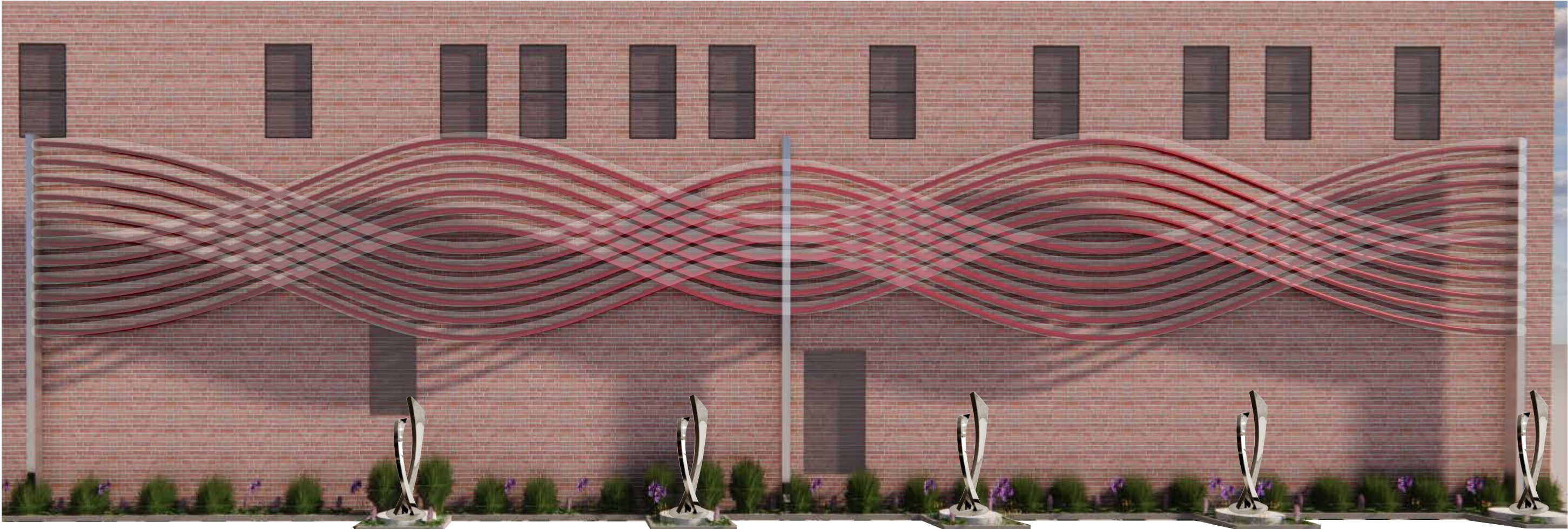

ELEVATION

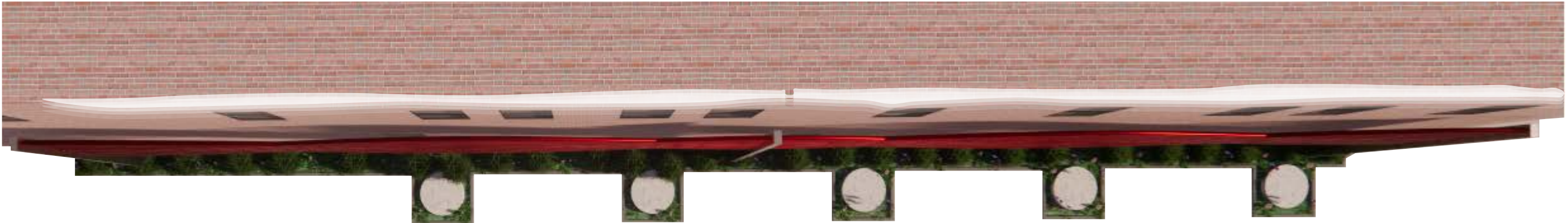

PLAN

Ribbon Wall

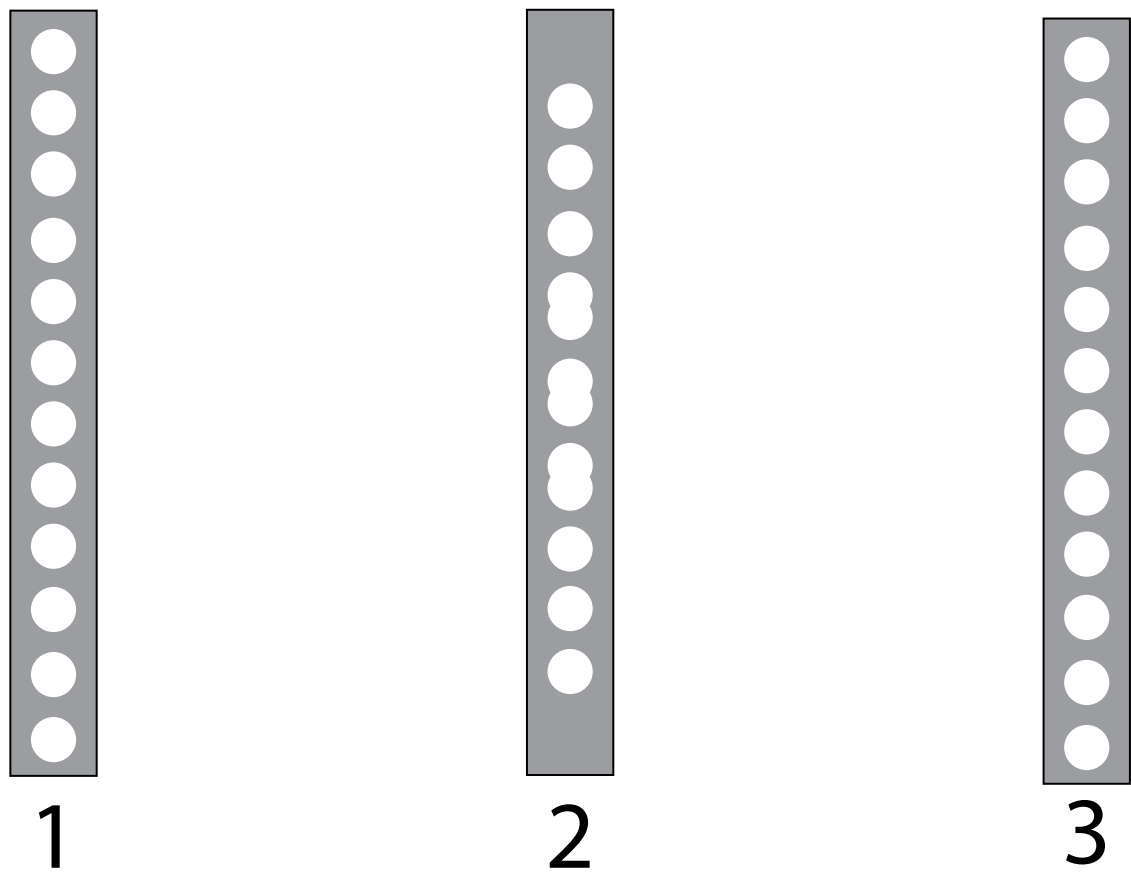

Support Structures

Materiality: Construction material is 2.25" steel tubing that has been powder coated in order to provide that wonderful red color. Support poles are 6" stainless steel square tubing.

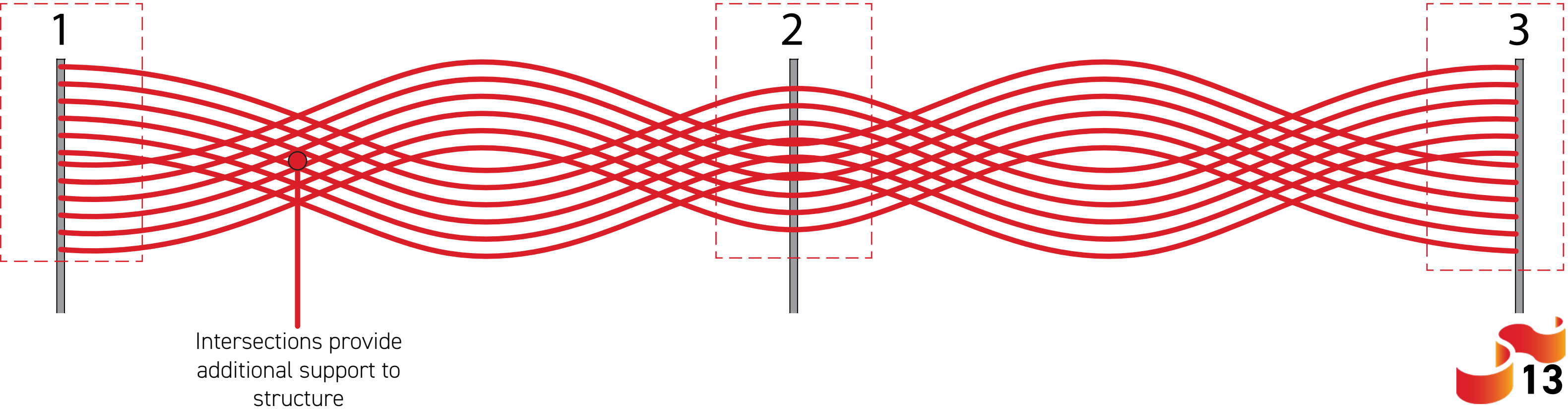
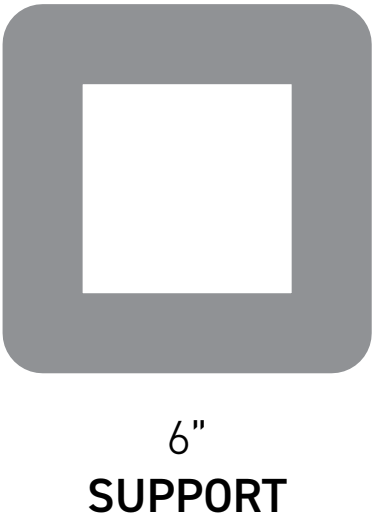
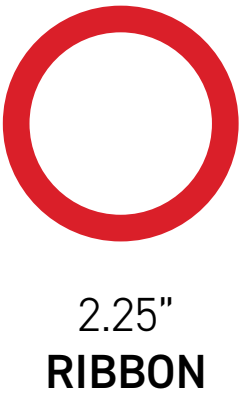

Ribbon Wall

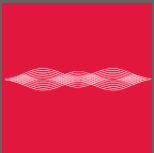

The gallery ribbon takes inspiration from the other forms of the ribbon used as shade structures, sitting and gathering structures as well as encouraging exploration in forms of play. I took the adaptability of the ribbon pattern and its ability to provide depth and meaning for an entire space while also having the form to draw your eyes and want to spend time in the plaza. Also will be lighted which will make the site feel bigger and introduce verticality which will in turn create a gallery feel. The lighting also provides a unique opportunity to showcase events that the community cares about and celebrates.

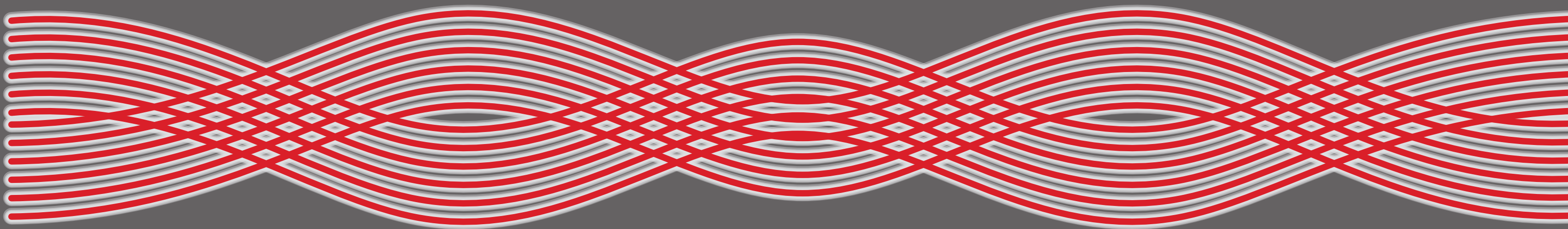

In the spirit of communal celebration San Francisco City Hall lights up every single night in order to honor someone from the community, pay our respects after a tragedy, and to celebrate movements that are helping to liberate suppressed people. Longmont's smaller version could give the community more social interaction and some identity to other places. Seen below are just some of the examples seen at SF City Hall including celebrating Christmas, LGBTQ Month, in recognition of remembering Kobe Bryant.



Ribbon Wall

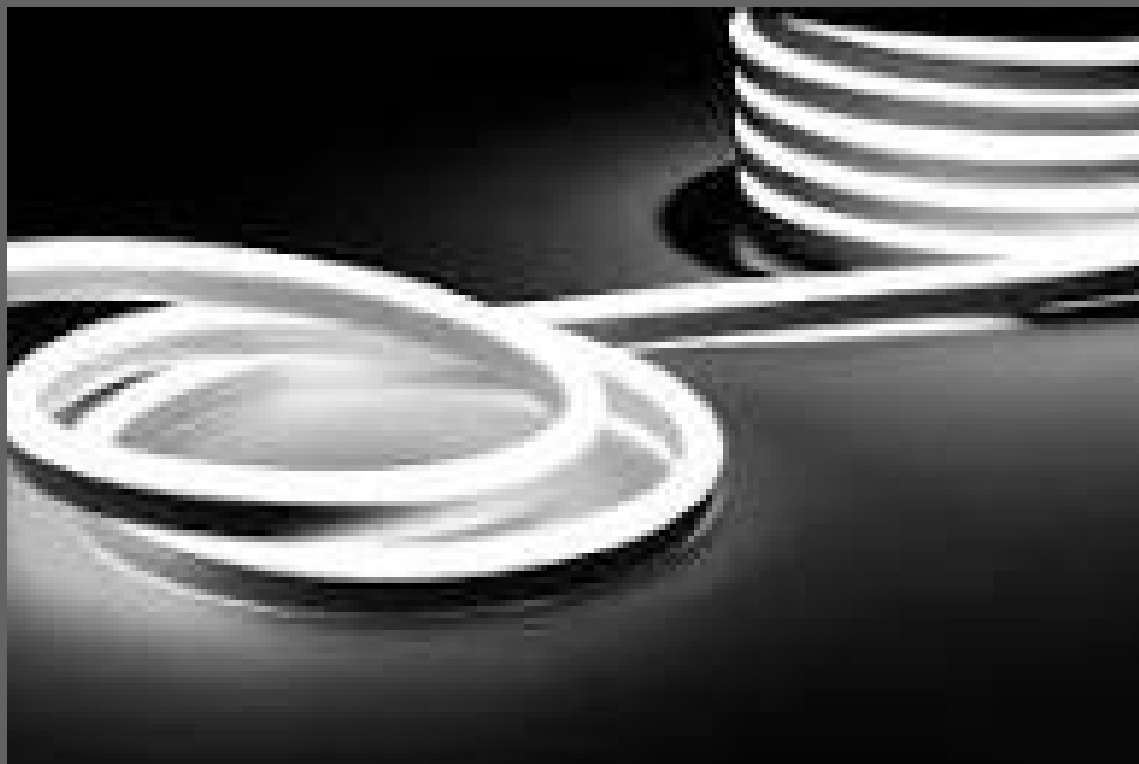
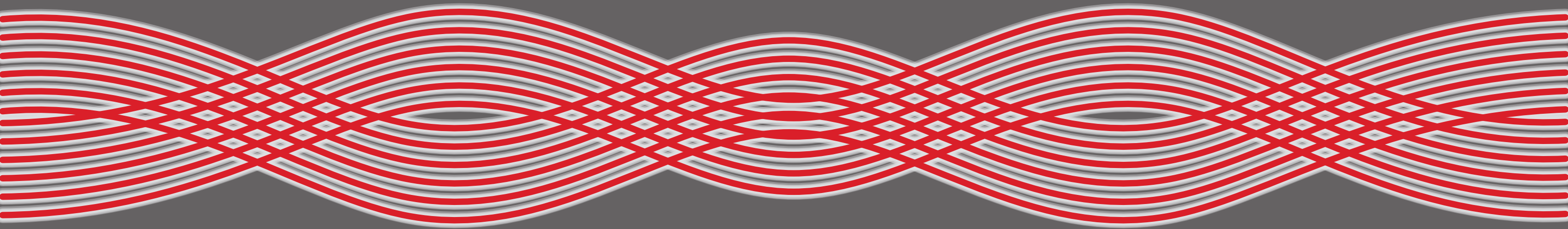

Rope lights provide a very nice consistent light over long distances. Also provide the option for custom colors and patterns. They provide great inspiration for artists and the community as a whole while adding a fun aesthetic that is not seen often in smaller cities.



Issues & Inspiration | Fountain



Pitfalls of the Current Fountain

The current fountain leaks water when used.

The material does not blend with other materials on the site.

The fountain also loses function during colder months, when water will freeze.

How can a new fountain become an art piece that looks good in colder months, but also functions during the warmer months?



Artistic Form, Water, Interaction

Designing the fountain with an artistic fountain will allow it to become a point of interest even in the snow

By playing with the form, the fountain can be something that people can walk through and interact with

How can the fountain use materials that match the other artistic features of the plaza?

Fountain Details

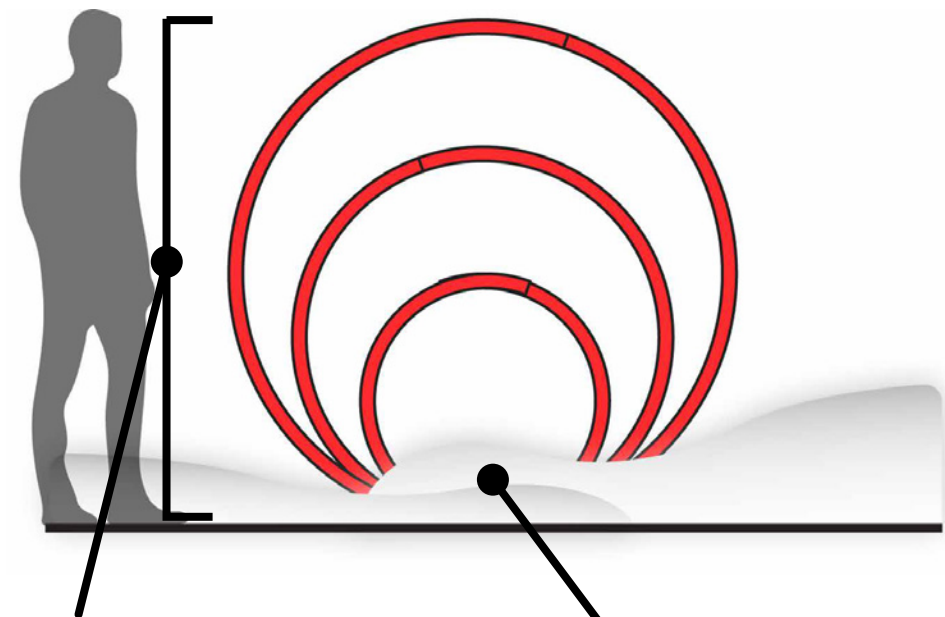

6' Tall
Size allows for meaningful interaction and creates interest.

Art in the Snow
Color and form emerge from snow to become a piece of art.

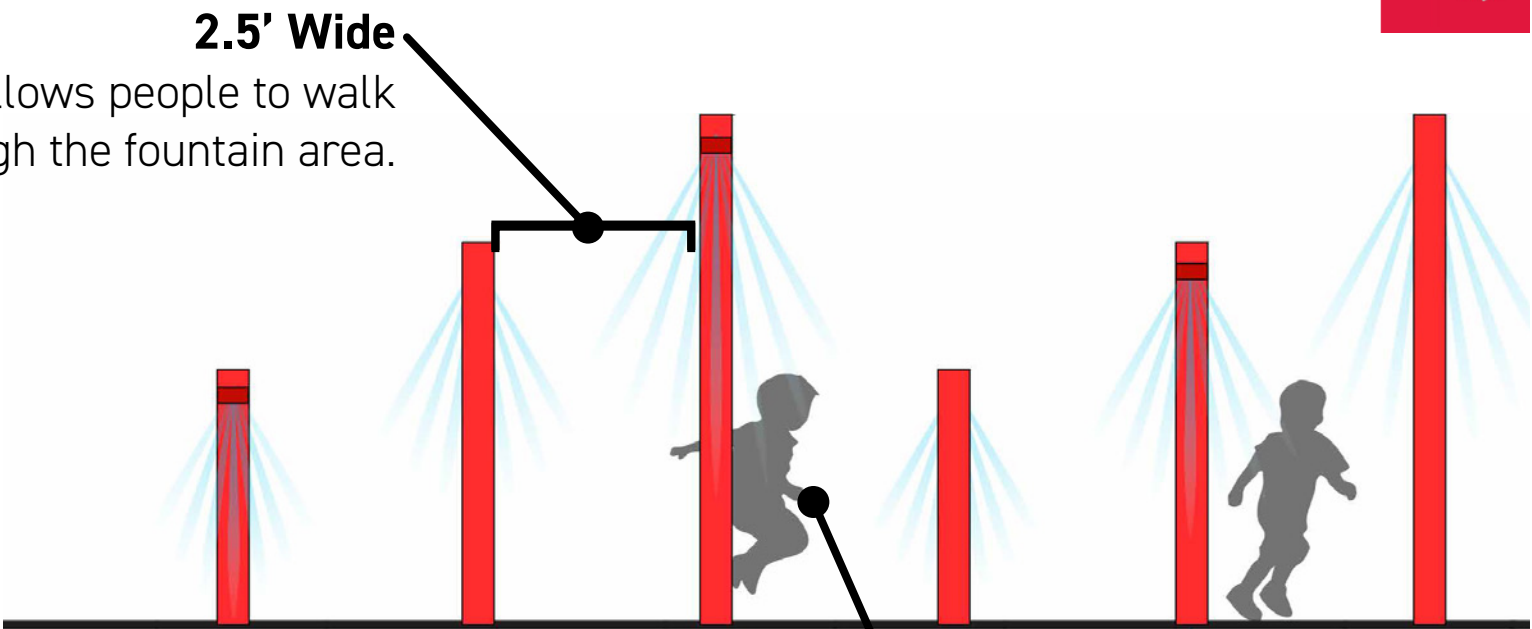

2.5' Wide
Width allows people to walk through the fountain area.

Moving Form
Can create a tunnel effect for kids to play and run through.

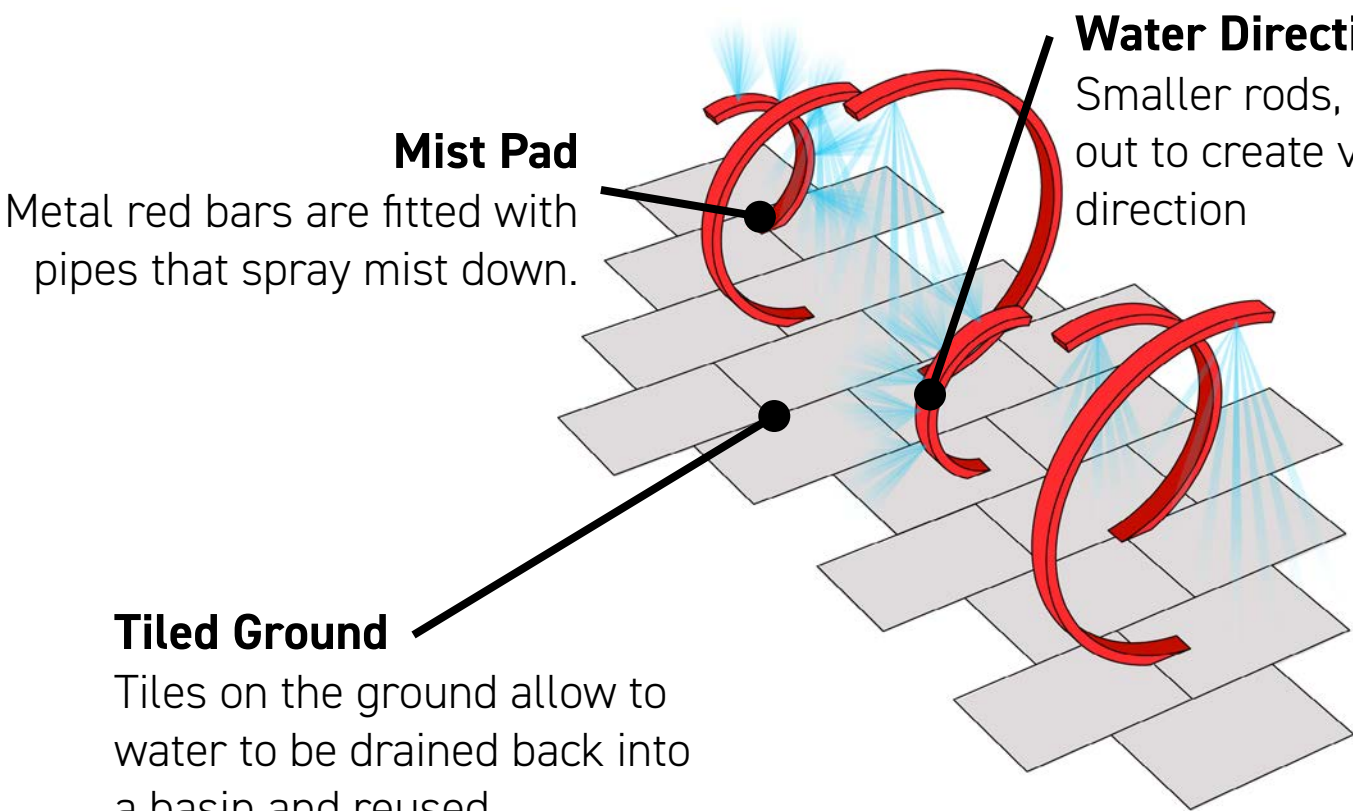

Mist Pad
Metal red bars are fitted with pipes that spray mist down.

Water Direction
Smaller rods, spray water out to create variety in water direction

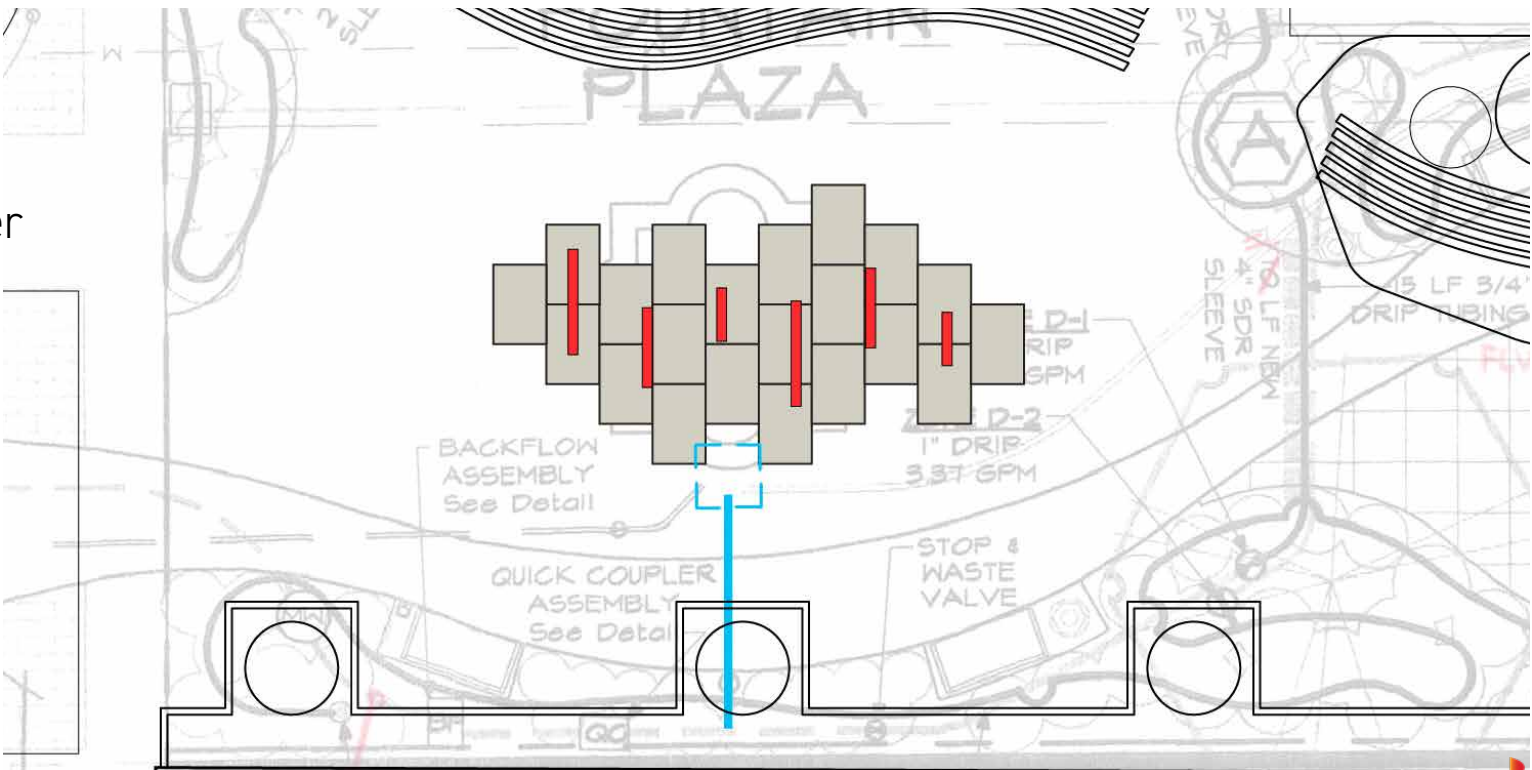

Placement
Placement utilizes existing piping for water.

Fountain Perspective



Stage Inspiration

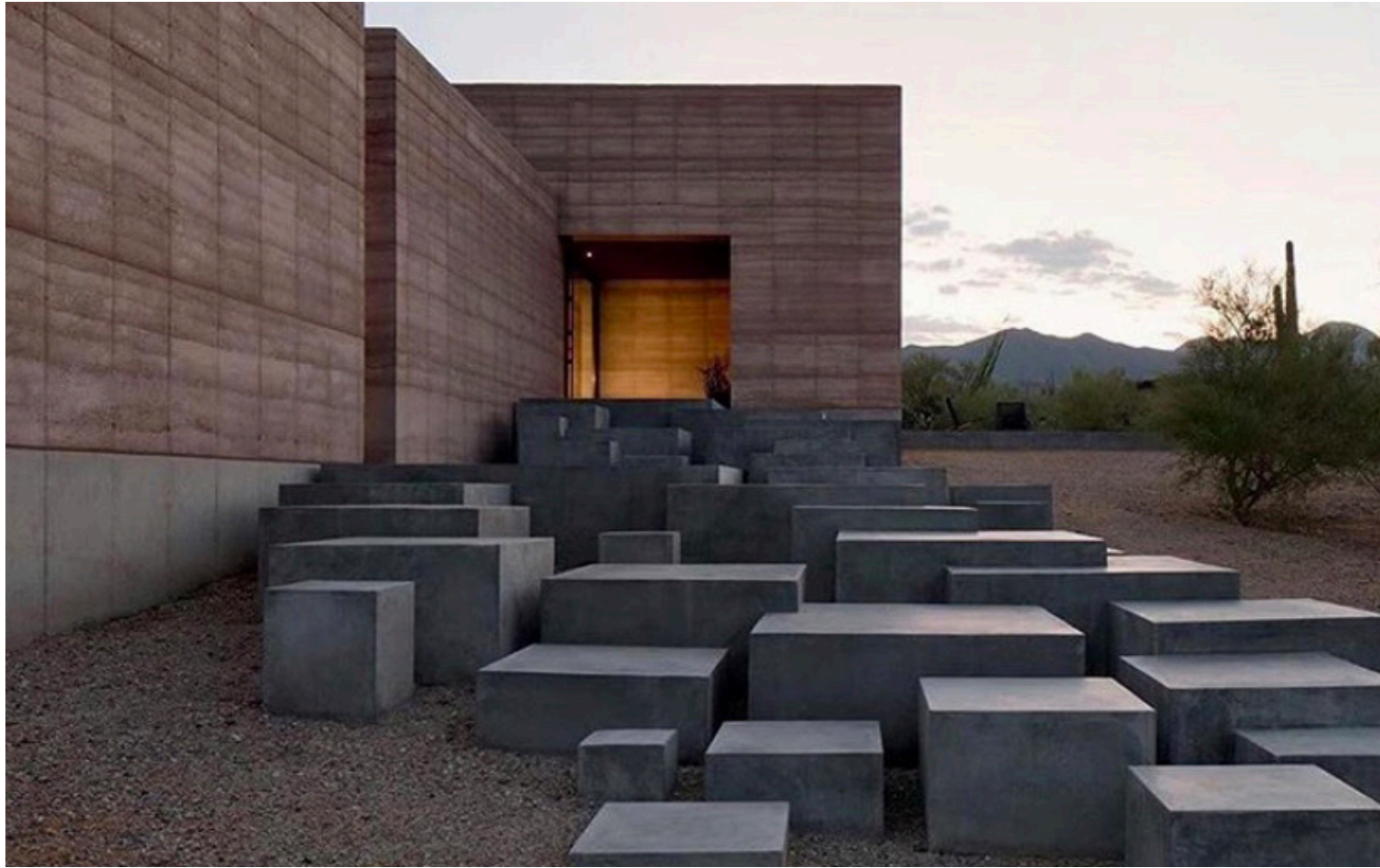

Interactive Steps for Play and Seating

Varying widths and heights of steps allows for different uses at different times of the year.

Angular design of steps creates contrast between the fluidity of The Ribbon and the plaza.

Creates seasonal interest during winter months.

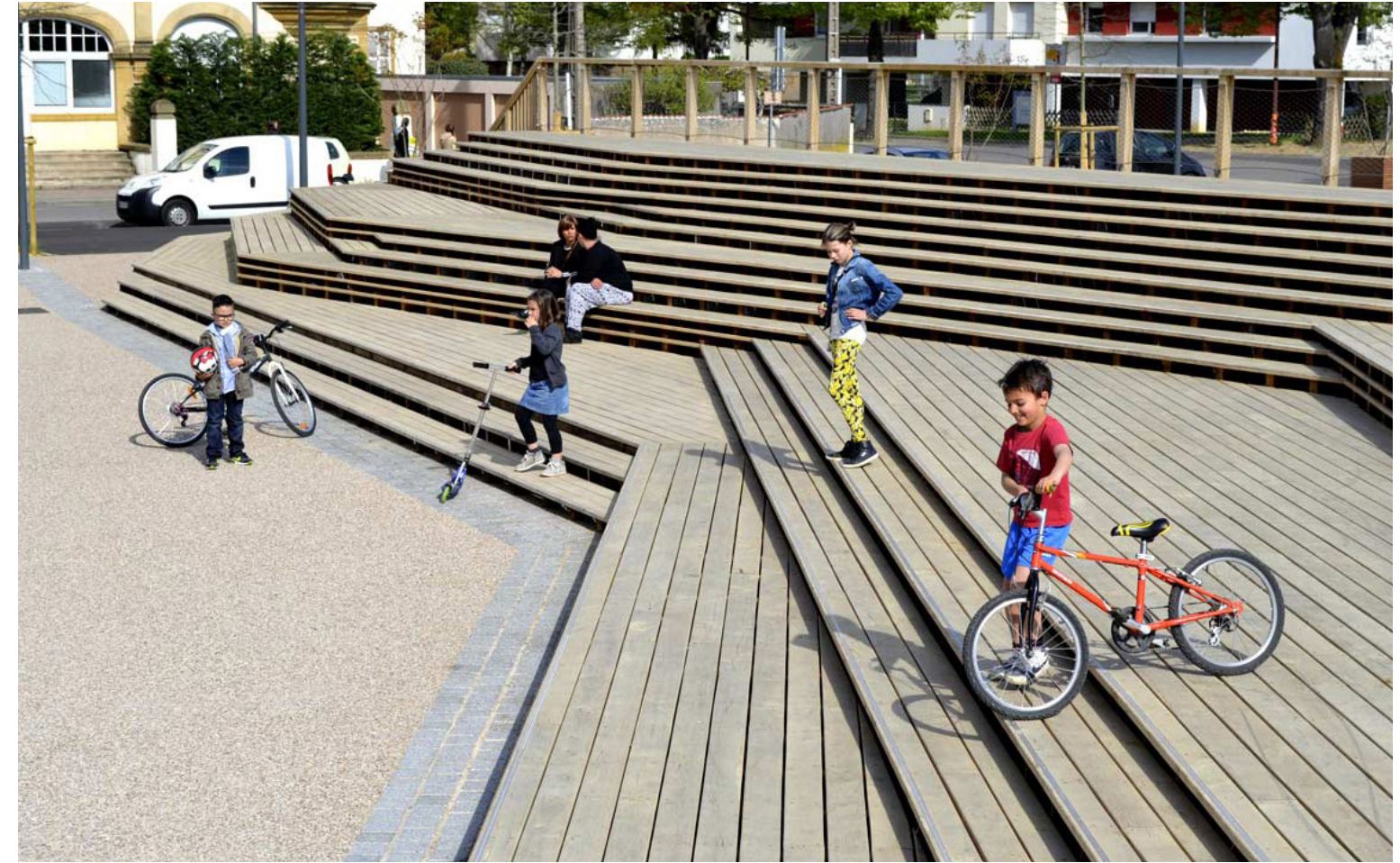

Multifunctionality: Entertainment and Play

The stage creates an artistic placemaking feature for entertainment and play.

The arrangement of concrete steps allows for multifunctionality.

Platform for stage allows for a full band when used for entertainment and seating/play when not in use.

Stage Details

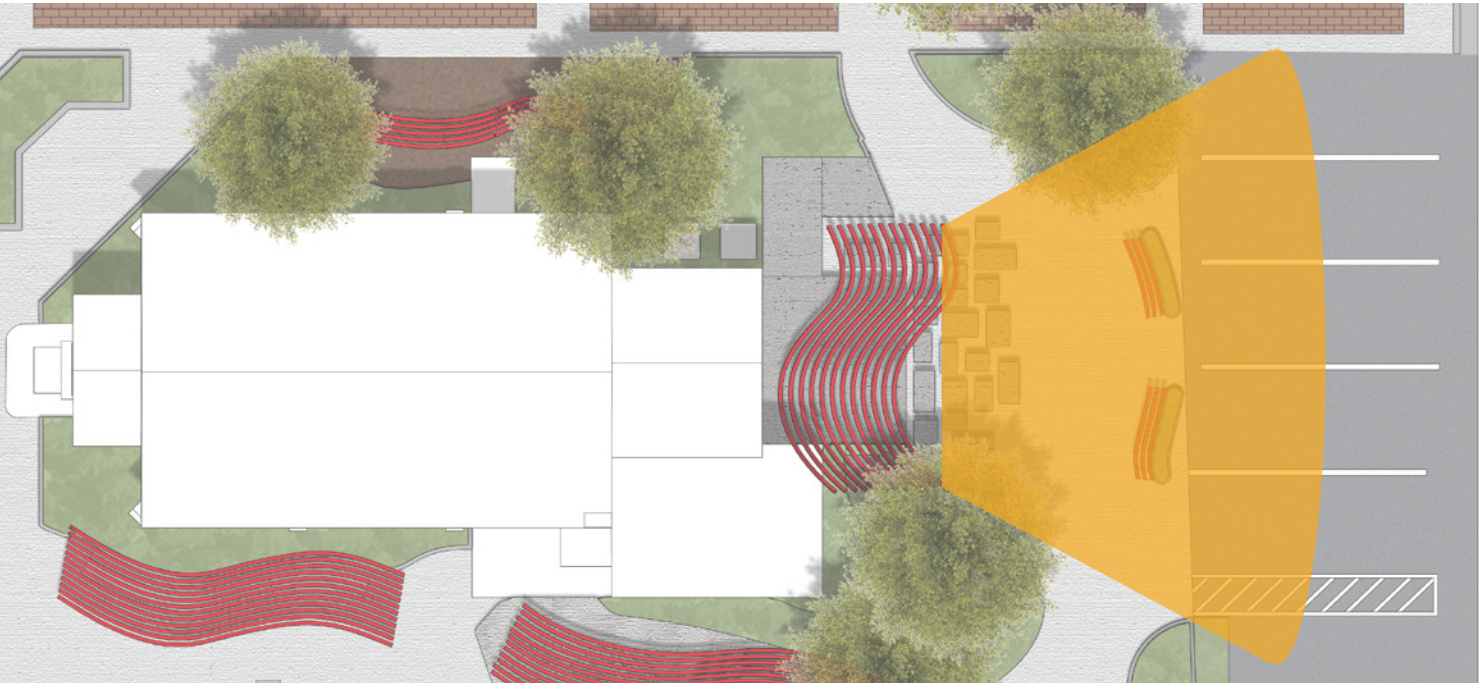
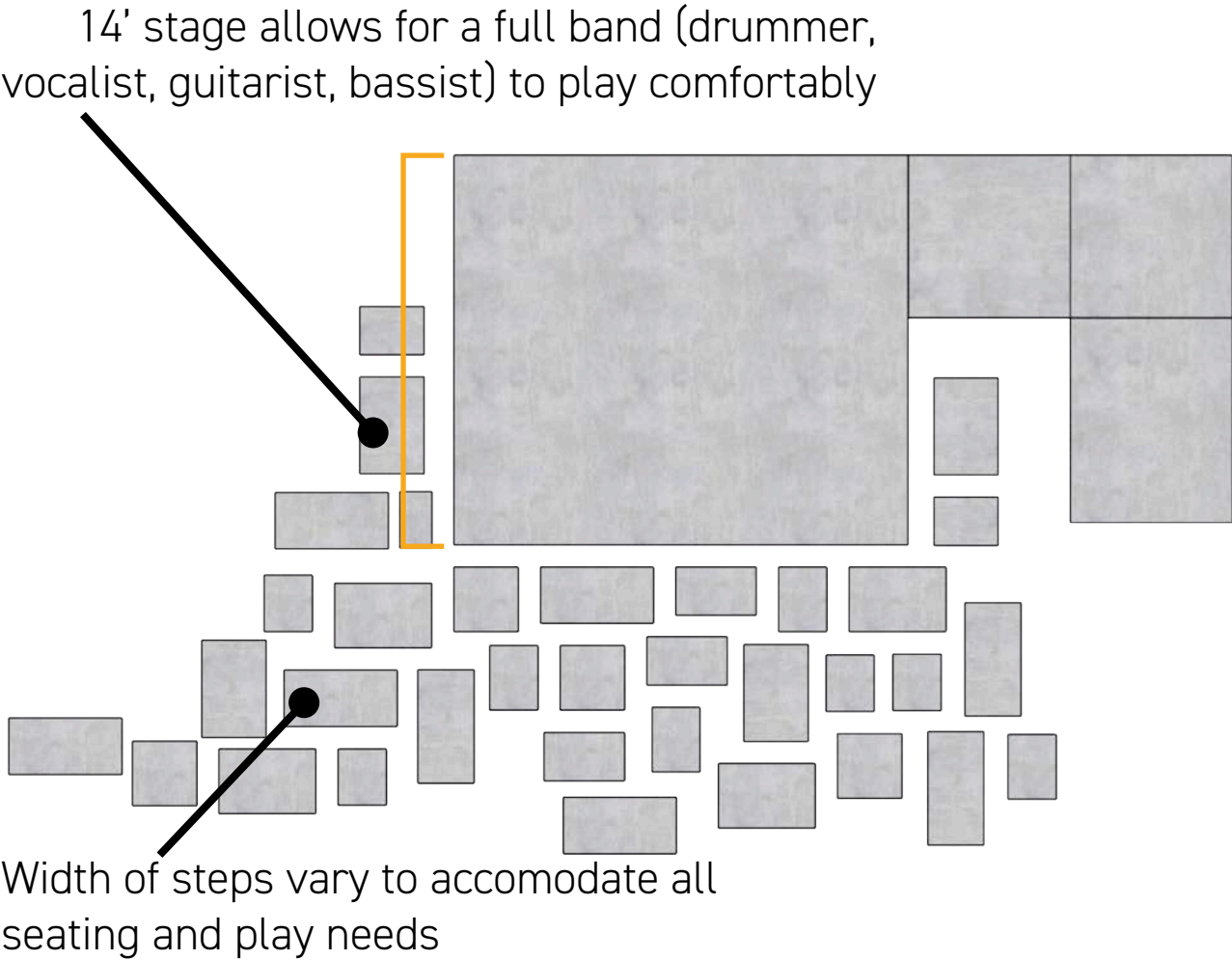
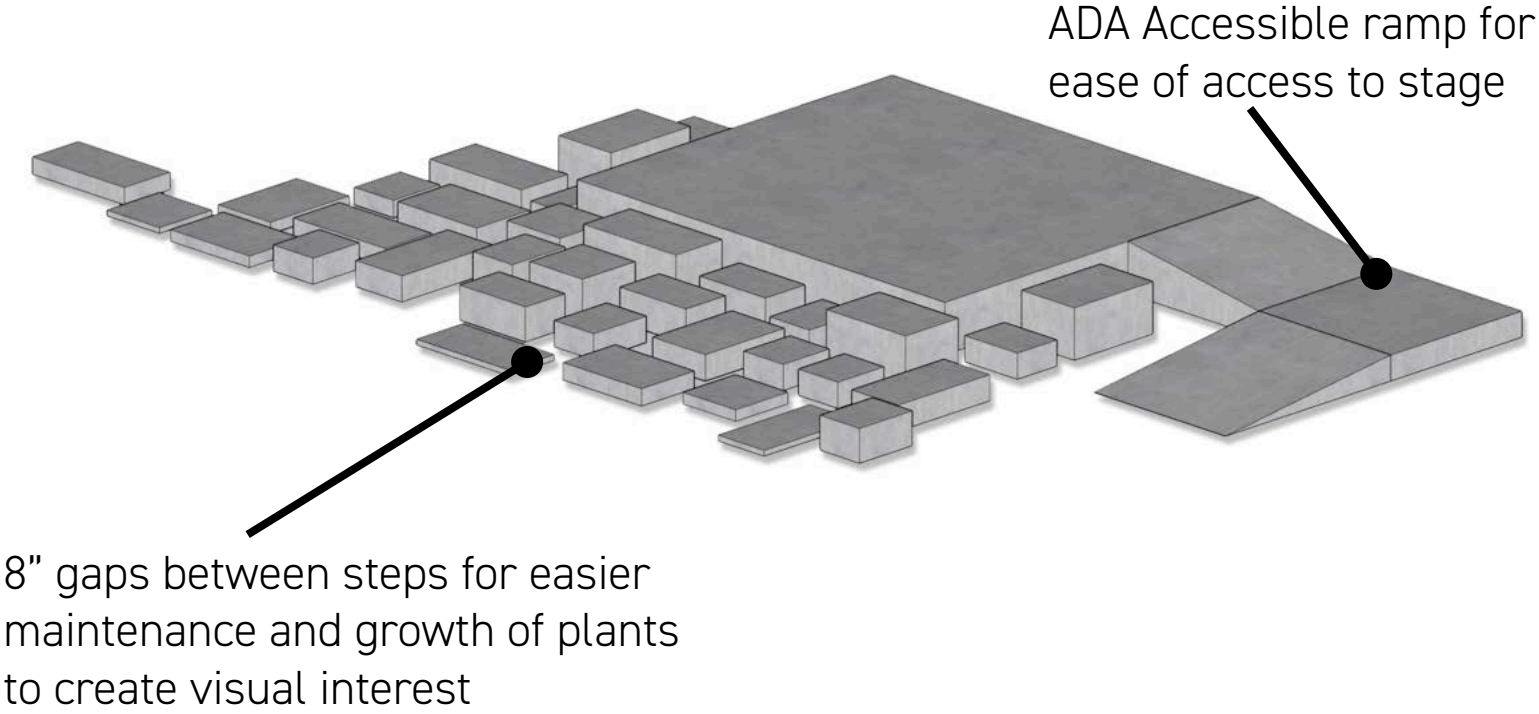
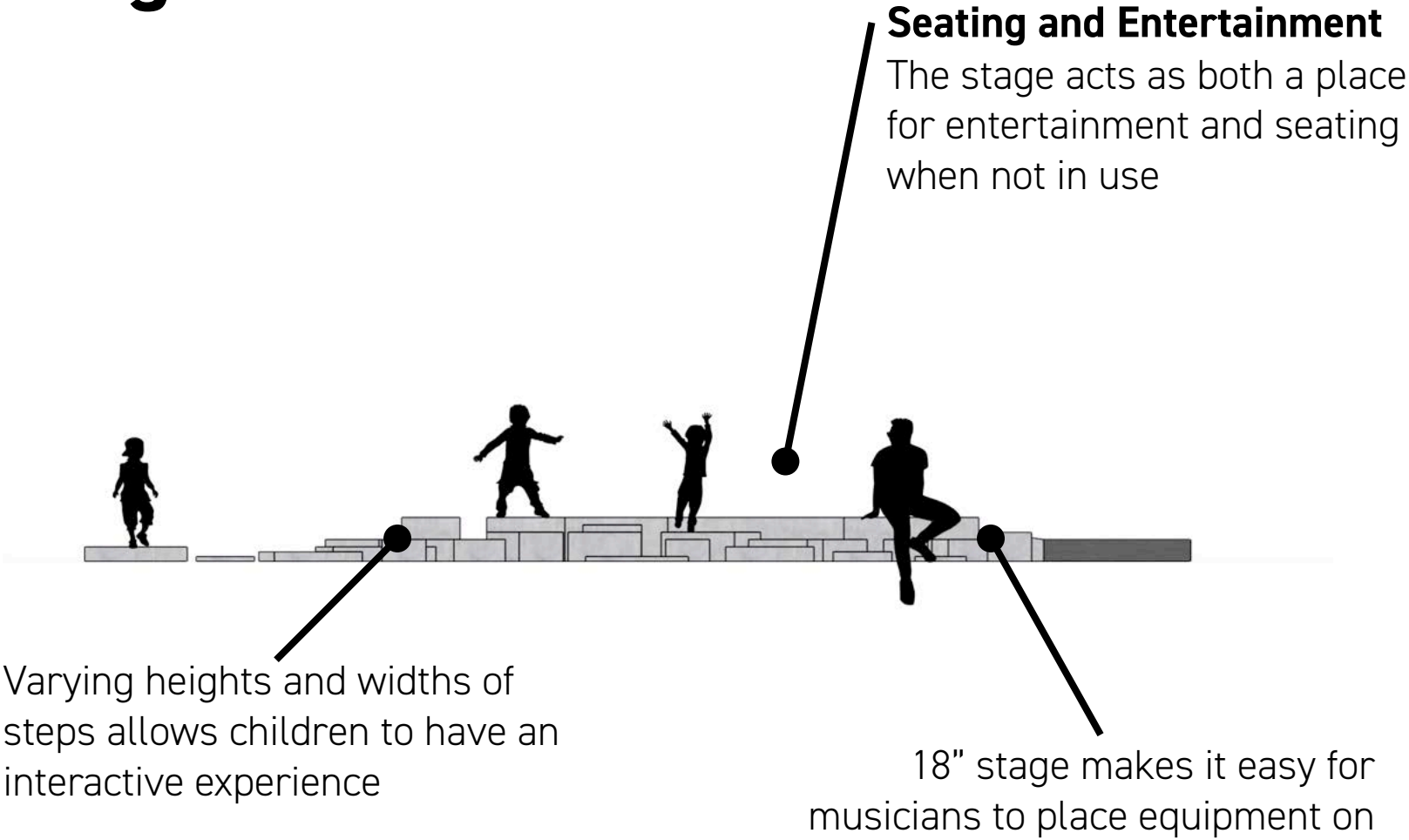

Creates active space that discourages transient residence, utilizes the alleyways for large events, retains parking, and creates a node for gathering

Stage Perspective I



Stage Perspective II



Fire Feature Details



Placement

The location selected is already geared toward harboring gatherings as it sits in a natural corner formed by the kitchen store and the southeast planters. The area is also the most heavily affected by snow build up, making it the optimal location for a heat source such as a fire feature.



Concrete Seating Formation

The arrangement of concrete blocks creates variable seating throughout the area and connects with the form of the stage.

3.5' Height

Height makes it a noticable element but isn't large enough to shelter someone.

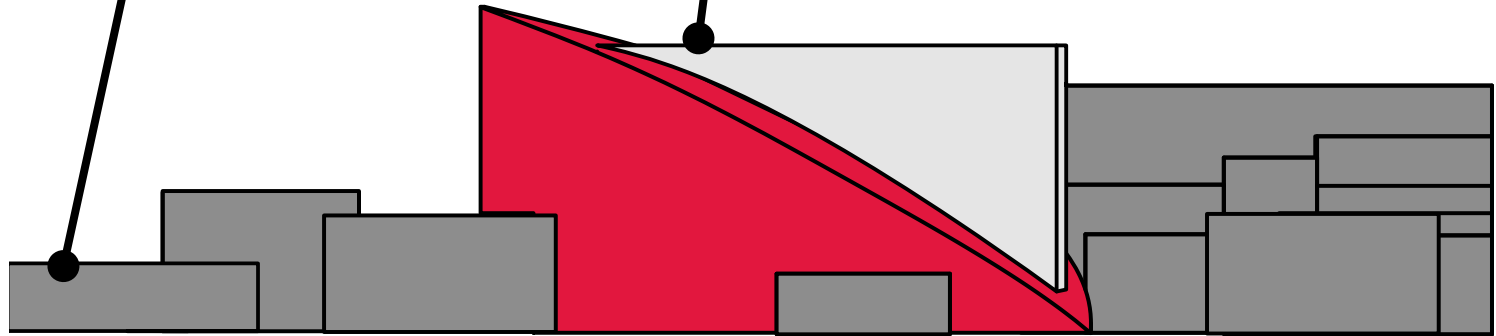

Tempered Glass Panes

Allows people to get closer to the feature than an open flame would.

Red Metal Cladding

Maintains the materiality of the ribbon to maintain site identity.

Interior Aluminum Frame

Allows for easier maintenance and facilitates changes in cladding.

Gas Fire

Reduces both pollution and maintenance.

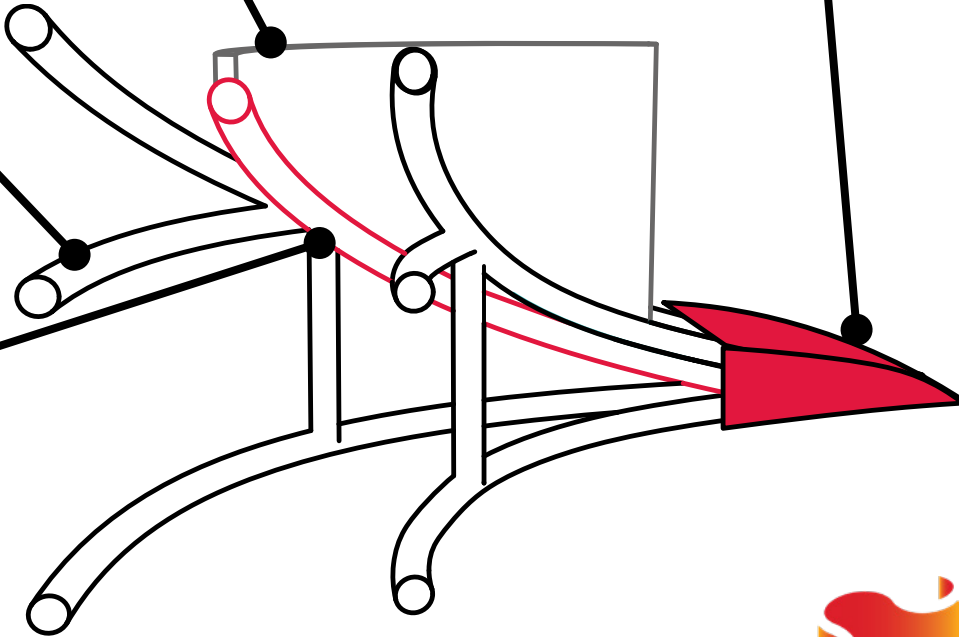

Fire Feature Perspective



Planting Concept

This selection of plants is advantageous for several reasons. The selection consists largely of native plants which will be able to survive with minimal irrigation once established. Additionally, they require very little maintenance when compared with the roses and trimmed hedges currently on site. The plants we selected were chosen for their variety of colors and how they manifest their color. Some have underlying tones of color, some have vibrant blooms, and others will only show their strongest colors right before dropping their leaves. This variety helps to ensure that the site maintains color throughout the year as much as possible.

LIVELY

GROUNDCOVERS



Sulphur Flower
(perennial)
Eriogonum umbellatum

PERENNIALS



Black-Eyed Susan
Rudbeckia hirta



Blanketflower
Gaillardia aristata



Torch Lily
Kniphofia uvaria



Scarlet Bugler
Penstemon
Penstemon barbatus



Prairie Coneflower
Ratibida columnifera

SHRUBS



Cinquefoil
Potentilla



Skunkbush Sumac
Rhus trilobata



Golden Currant
Ribes aureum

THE FOLLOWING PLANTS ARE:

- NATIVE
- LOW MAINTENANCE
- XERIC
- YEAR-ROUND INTEREST

GRASSES



Feather Reed Grass
Calamagrostis acutiflora



Little Bluestem
Schizachyrium scoparium

SERENE

GROUNDCOVERS



Bowles Periwinkle
Vicia minor 'Bowles'

PERENNIALS



Side-Bells
Penstemon
Penstemon secundiflorus



Gayfeather
Liatris punctata



Rocky Mountain
Penstemon
Penstemon strictus



Blue Mist Penstemon
Penstemon virens



Pitcher Sage
Salvia azurea

SHRUBS



Ruby Muhly
Muhlenbergia reverchonii



Silvery Leadplant
Amorpha canescens

Ozone Garden

What is ozone?

Ground-level ozone is formed when pollutants emitted by vehicles, power plants, industrial boilers, refineries, chemical plants, and other sources chemically react in the presence of sunlight. Ozone at ground level is a harmful air pollutant. Ozone is likely to reach unhealthy levels on hot sunny days in urban environments and can also be transported long distances by wind. Denver is ranked the 6th highest ozone-polluted city in the U.S., and the Denver Metro/Front Range Region has been out of compliance with U.S. Environmental Protection Agency standards for ground-level ozone since 2007.

What is an ozone garden?

An ozone garden is a garden made up of plants that serve as bio-indicators of ozone injury. These bio-indicators are plants that exhibit typical and verifiable responses when exposed to stress, such as ground-level ozone.

Why is this important for Longmont?

Main Street is a primary corridor to Rocky Mountain National Park and sees an average of 30,000 cars a day. Research and monitoring are showing the park's air quality is affected by air pollution coming from a variety of human-made sources. Air pollution in the park reduces visibility, increases ozone levels, and causes excess nitrogen deposition. By implementing a bio-indicator ozone garden in St. Stephen's Plaza, we can bring awareness and education of this issue to the people of Longmont and those passing through.

Where we are currently...

We have been in contact with Dr. Danica Lombardozzi, a project scientist in the Climate and Global Dynamics (CGD) laboratory at NCAR and co-founder of Boulder's Ozone Gardens. She was delighted to hear of a potential indicator garden in Longmont and offered insight to make this a feasible project. Though we are still in communication to determine the best location for St. Stephen's Plaza, she is happy to give us seeds from her gardens and templates for educational signage if needed.

Ozone Sensitive Species



Snap Bean
crop variety



La Chipper Potato
crop variety



Red Saxifrage

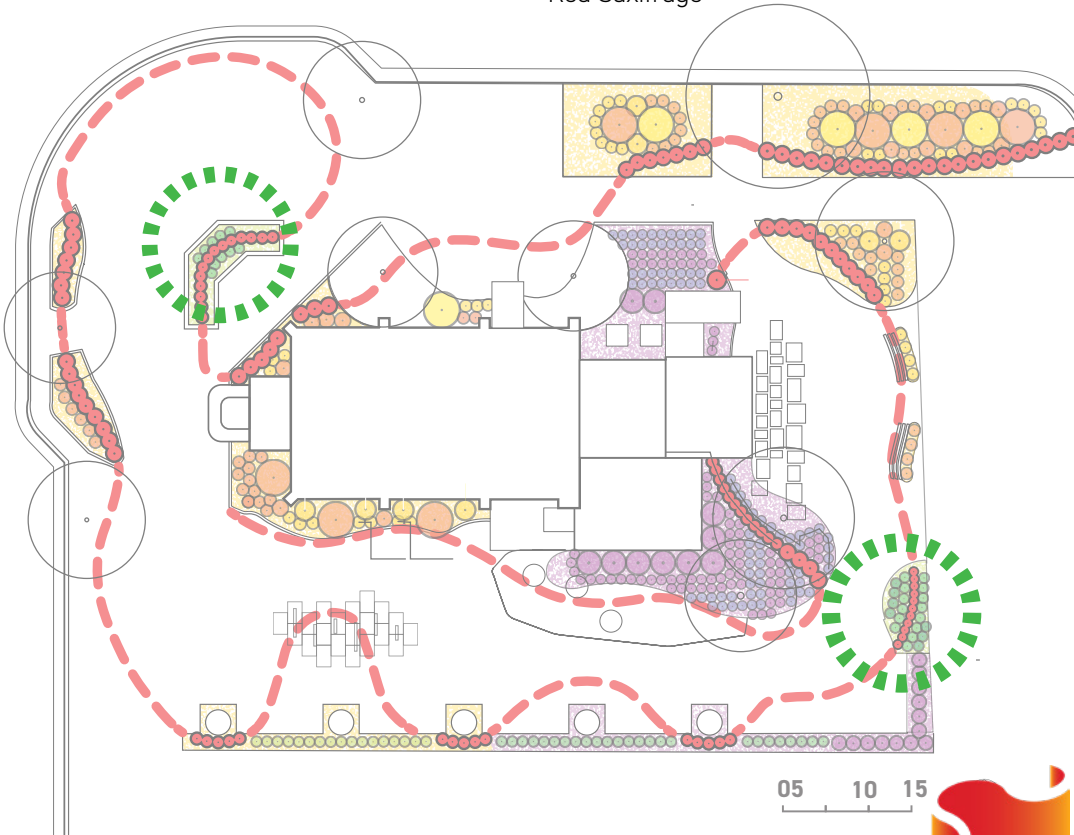

Planting Plan

Common Name	Abbreviation
Scarlet bugler penstemon	Pc
Blanketflower	Gp
Ruby Muhly	Mr
Golden currant	Ra
Cinquefoil	Pf
Black Eyed Susan	Rh
Sulphur Flower	Eu
Torch Lily	Ku
Prairie Coneflower	Rc
Three leaf sumac	Rt
Dotted Gayfeather	Lp
Rocky Mountain Penstemon	Ps
Purple Lupine	Lpo
Silvery Leadplant	Ac
Bowles Periwinkle	Vm
Blue Mist Penstemon	Pv
Pitcher Sage	Sa
Snap Beans	Pvu
La Chipper Potatoes	St
Red Saxifrage	Sr
Little Bluestem	Ss
Feather Reed Grass	Ca

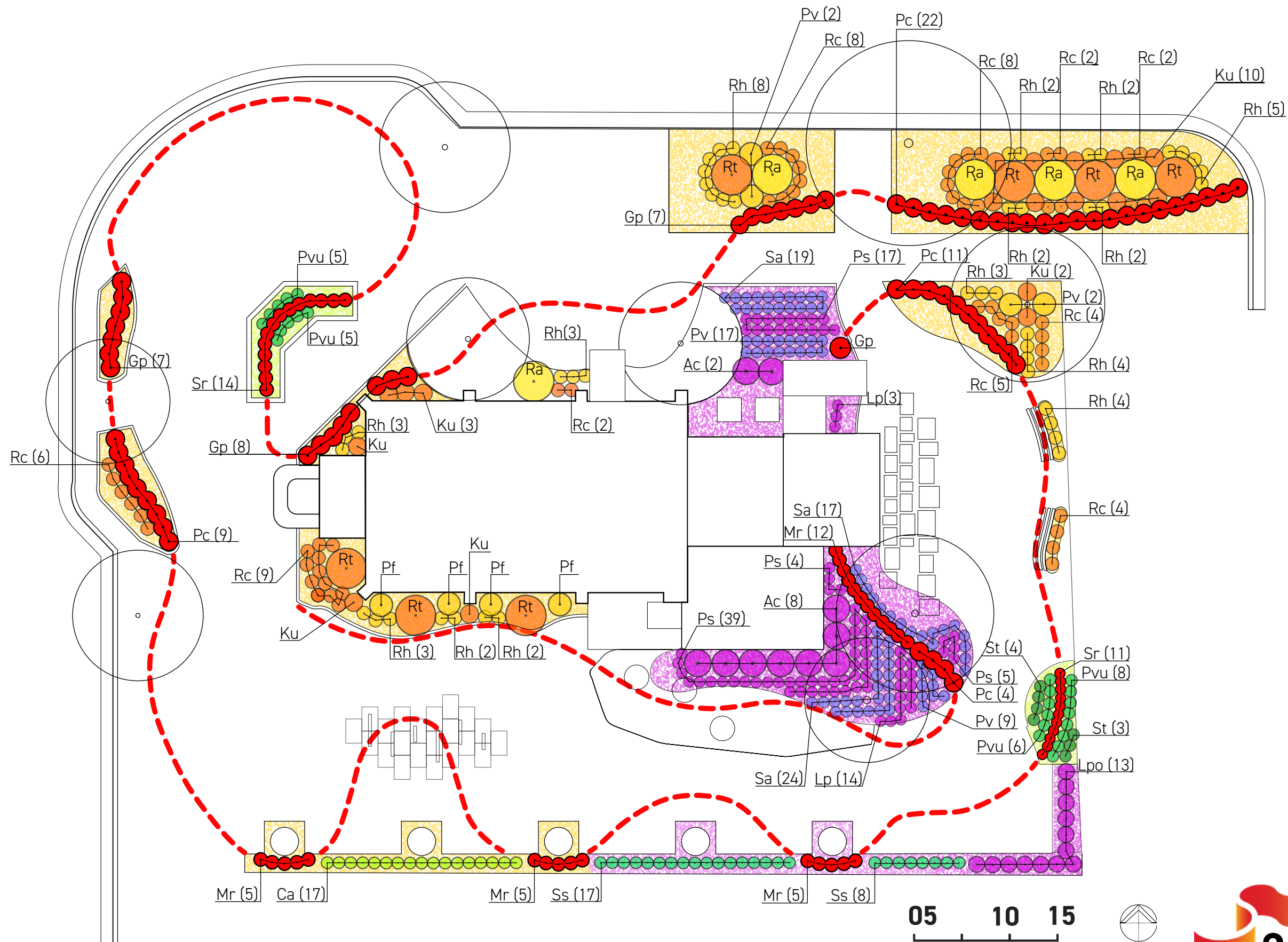

Plant Schedule

Common Name	Scientific Name	Abbreviation	Count	
Scarlet bugler penstemon	Penstemon centranthifolius	Pc	46	
Blanketflower	Gaillardia pulchella	Gp	23	
Ruby Muhly	Muhlenbergia reverchonii	Mr	27	
Golden currant	Ribes aureum	Ra	5	
Cinquefoil	Potentilla fructosa	Pf	8	
Black Eyed Susan	Rudbeckia Hirta	Rh	42	
Sulphur Flower	Eriogonum umbellatum	Eu	-	
Torch Lily	Kniphofia uvaria	Ku	17	
Prairie Coneflower	Ratibida columnifera	Rc	54	
Three leaf sumac	Rhus trilobata	Rt	7	
Dotted Gayfeather	Liatris punctata	Lp	17	
Rocky Mountain Penstemon	Penstemon strictus	Ps	61	
Purple Lupine	Lupinus polyphyllus	Lpo	13	
Silvery Leadplant	Amorpha canescens	Ac	13	
Bowles Periwinkle	Vinca minor	Vm	-	
Blue Mist Penstemon	Penstemon virens	Pv	23	
Pitcher Sage	Salvia Azurea	Sa	60	
Snap Beans	Phaseolus vulgaris	Pvu	19	
La Chipper Potatoes	Solanum tuberosum	St	7	
Red Saxifrage	Saxifraga rocco	Sr	25	
Little Bluestem	Schizachyrium scoparium	Ss	25	
Feather Reed Grass	Calamagrostis acutiflora	Ca	17	

Existing lighting

The lighting arrangement that is currently on site does seem to provide sufficient light for the most part, but does leave a few areas unlit, which leaves them open to unwanted activities. Additionally some of the lamp posts are placed at awkward locations that don't lend themselves to creating a fluid and artistic space.



Proposed lighting

This proposed lighting arrangement would allow for better circulation throughout the site as well as providing an attraction for night life. In addition it will illuminate more areas of the site that have the potential to harbor nefarious activities. Lighting along the wall on the south edge of the site and along the benches will be oriented downward, so as not to disturb the residents living in that building.

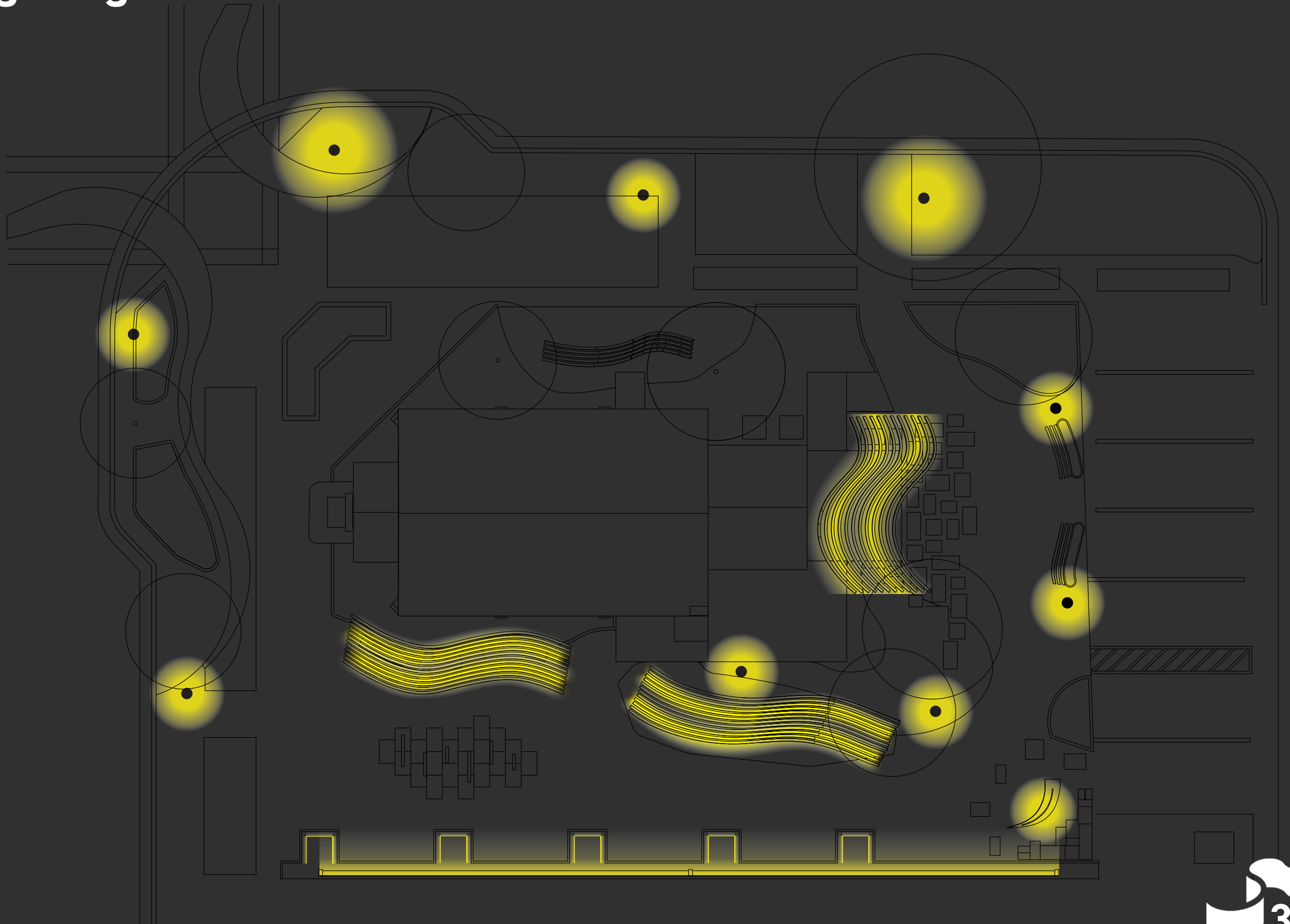

Demolition Plan

- Moved
- Demoed
- Proposed
- Light Fixtures

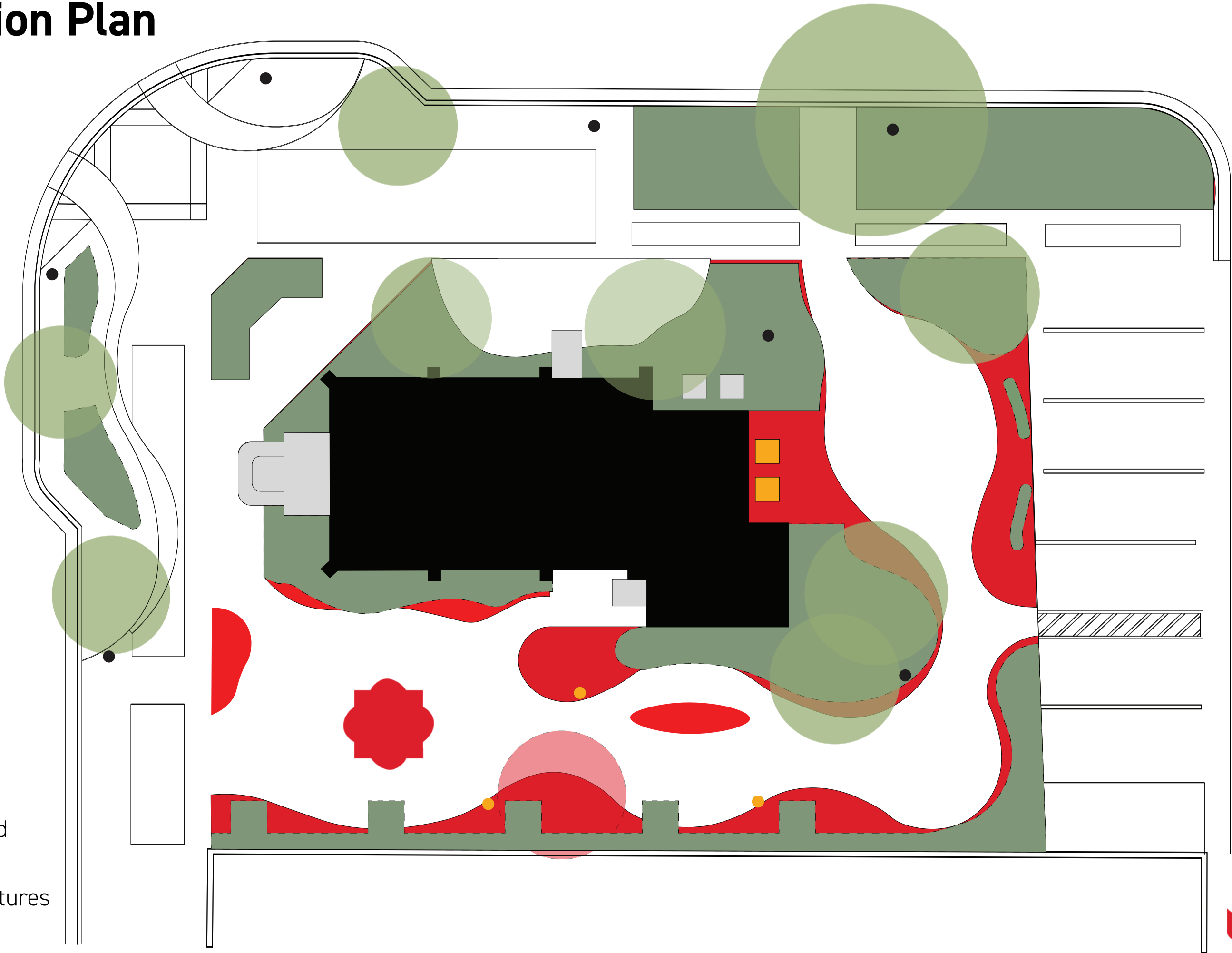

Phasing Plan

- Phase I:**
 - Establish plant beds
 - Install new paving
 - Construct gallery ribbon
 - Install new fountain
 - Rearrange art pedestals

- Phase II:**
 - Install ribbon structures
 - Install stage
 - Install The Ribbon play

- Phase III:**
 - Install fire feature

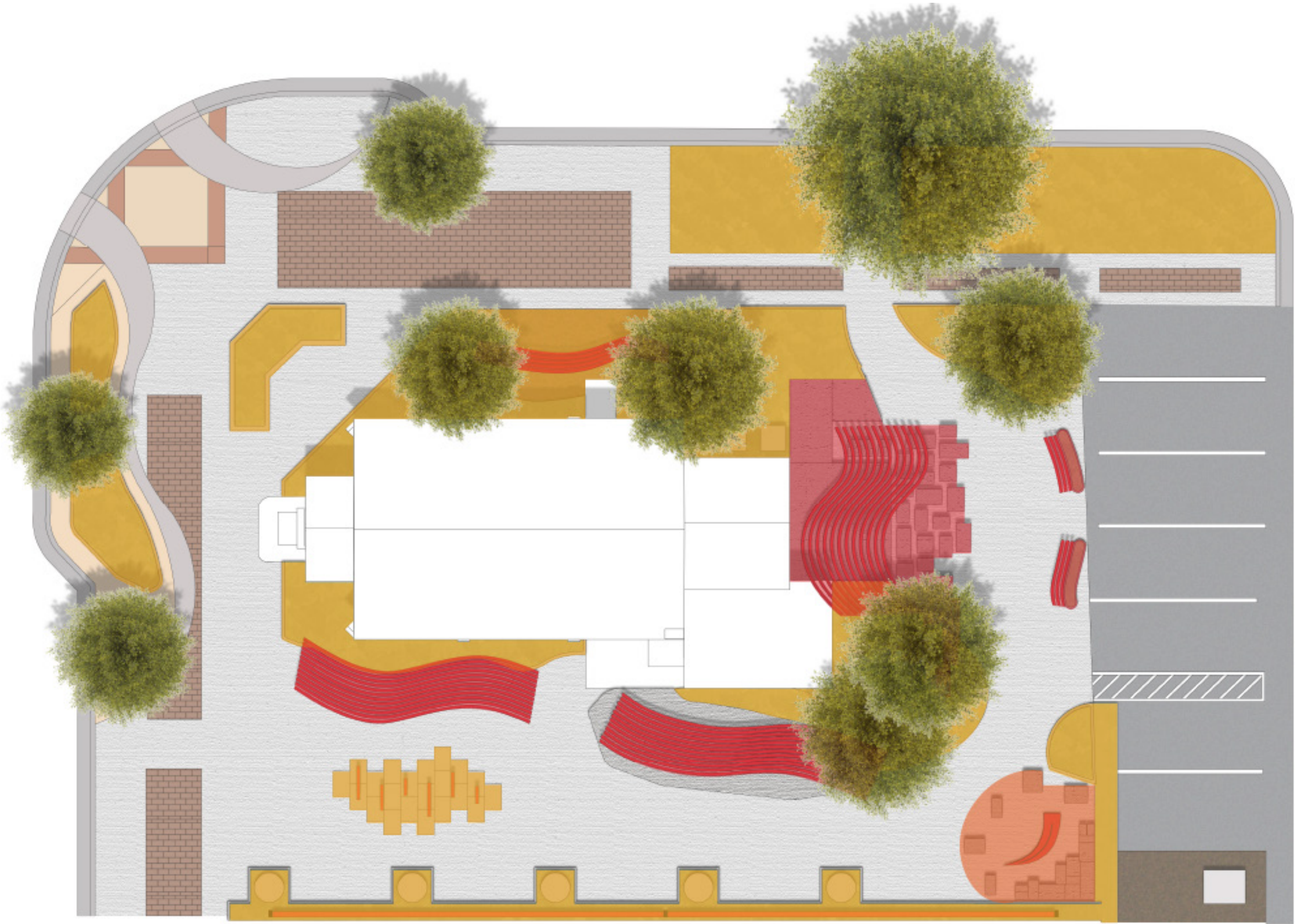

Art Envisioned Cost Plan

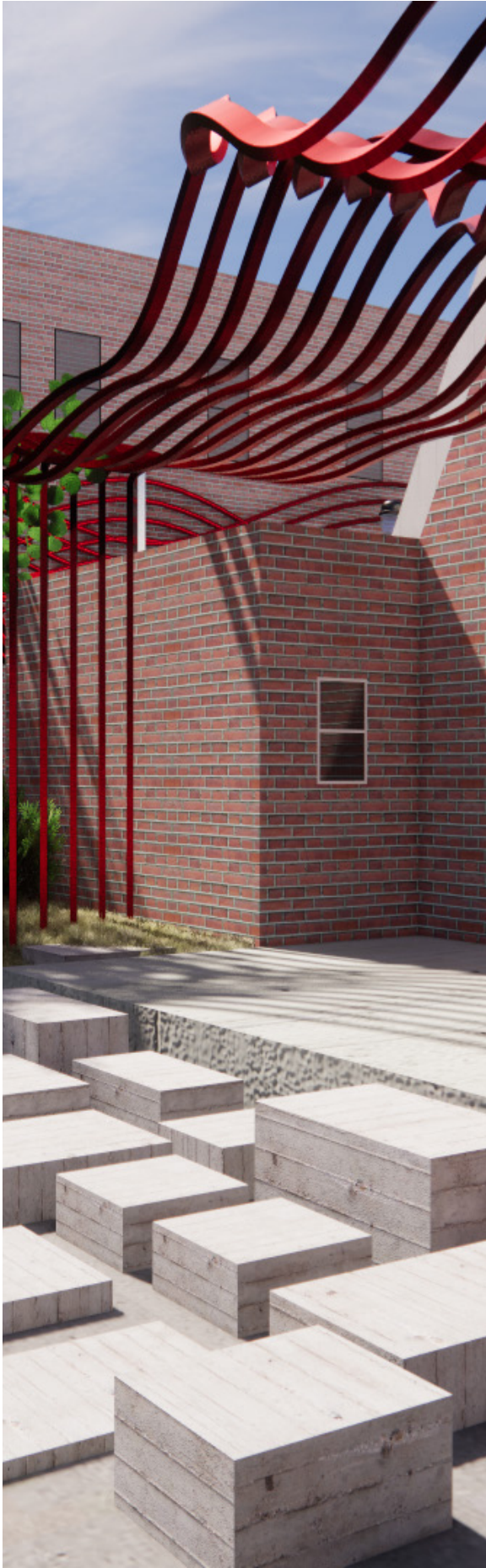

Total Material Cost Estimate: \$22,314

Note: Construction & Demolition are not included

The Ribbon

Cost: \$11,586

Metal Rods - \$7,706
Anchor Bolts - \$100

Powder Coating - \$3,000
Concrete Foundation - \$780

Maintenance:

No maintenance needed

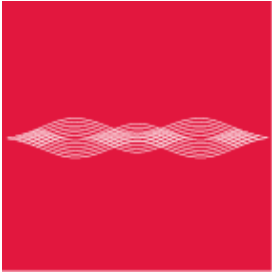

Ribbon Wall

Cost: \$4,500

Metal Rods - \$2,000 Pedestals - \$500
Powder Coating - \$1,000 Lighting - \$1,000

Maintenance:

Replacement of lights every 3 years



Fountain

Cost: \$703

Metal Rods - \$177 Mist Pad Tiles - \$286
Powder Coating - \$200 Concrete Foundation - \$20
Anchor Bolts - \$20

Maintenance:

Will need snow removal during colder months

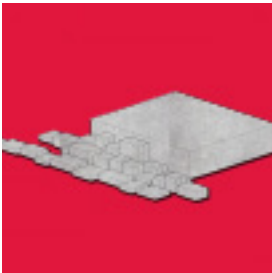

Stage

Cost: \$1,420

Concrete - \$1,420

Maintenance:

General cleaning



Fire Feature

Cost: \$1,710

Cladding \$210 Internal Structure & Piping \$200
Glass Panes \$800 Concrete Seating Formation \$350
Powder Coating - \$150

Maintenance:

Gas Line Maintenance & Cleaning



Plants

Cost: \$2,395

Estimated based on counts listed in planting schedule

Maintenance:

Irrigation should continue until plants become established.
May require annual trimming

Art Envisioned



■ Longmont's Creative Node

Art Envisioned develops the plaza into an identifiable creative node that can act as an attraction within Downtown Longmont's Creative District. All of our design elements will further strengthen the image of the plaza.

■ More Efficient Gathering Space

Art Envisioned will open up the back portion of the plaza to bigger events to utilize the redesigned alleyways. Additionally the front of plaza retains open space for crowds of people.

■ Meaningful Planting Design

Art Envisioned will update the planting plan to choose plants that will thrive within Colorado's climate. Utilizing color and form the plants will now provide color and winter interest through all the seasons. Additionally, **Art Envisioned** will use Ozone Gardens to make a conscious environmental statement that often is not present in urban areas.

■ Promoting the Community

Through strengthening the interaction of the rotating art program and increasing the potential of events **Art Envisioned** will help promote community activity and engagement.



Thank You

